

FORM A - AREA

MASSACHUSETTS HISTORICAL COMMISSION
294 Washington Street, Boston, MA. 02108

Form numbers in this area	Area letter
478-489, 497, 1038-1040	N



Lexington

f area (if any) Bloomfield Street

l date or period 1872 to c. 1900

Sketch map. Draw a general map of the area indicating properties within it. Number each property for which individual inventory forms have been completed. Label streets (including route numbers, if any) and indicate north. (Attach a separate sheet if space here is not sufficient)

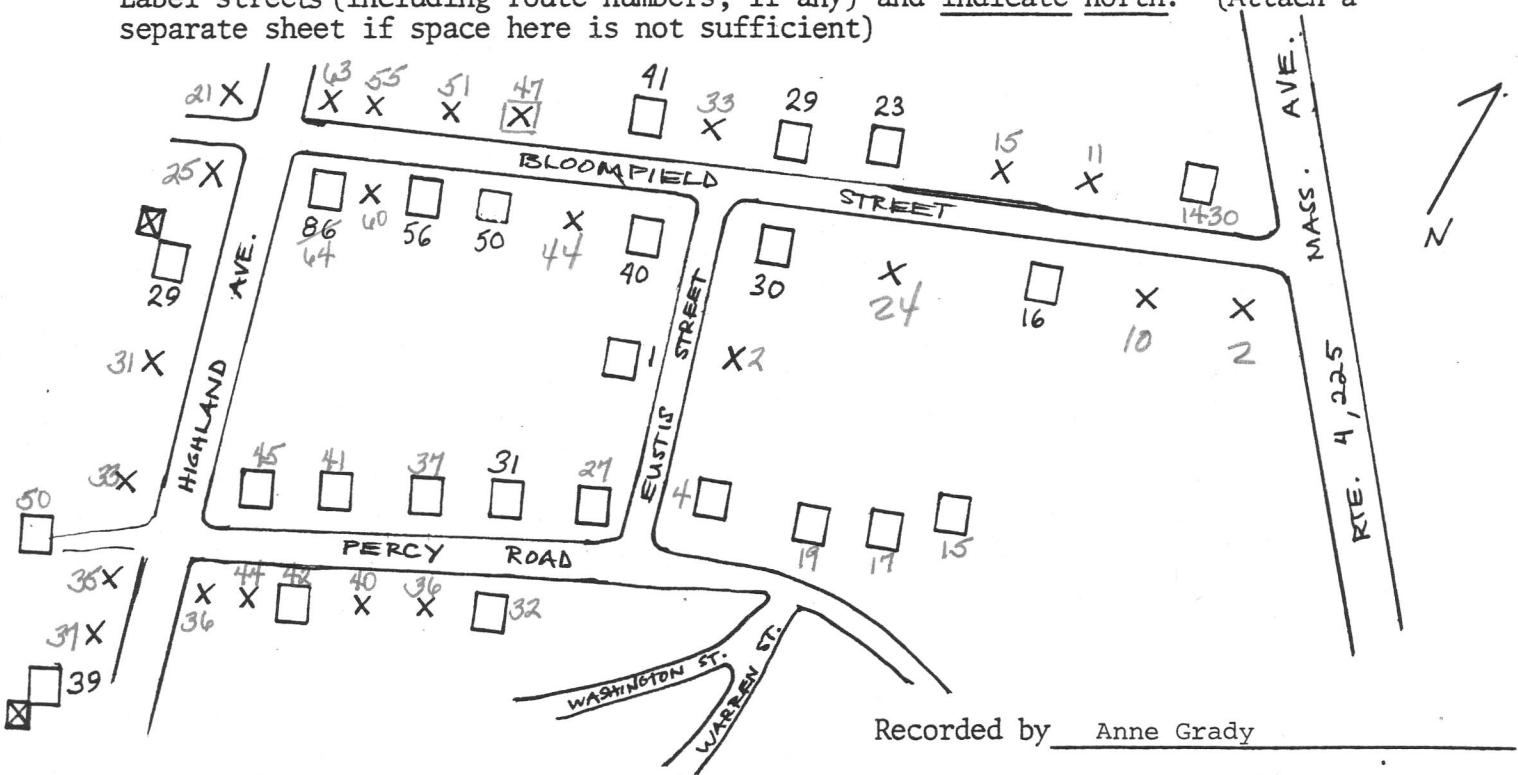

Recorded by Anne Grady

Organization Lexington Historical Commission

Date March, 1984

(Staple additional sheets here)