

105.44  
10.16  
118.67

71-2-28  
10/1  
10/1

145 37

80.52  
25.90  
106.42

300  
400  
1/10

110-44  
21-16-17  
6-20-17

2425  
1500  
5400  
10000  
13000

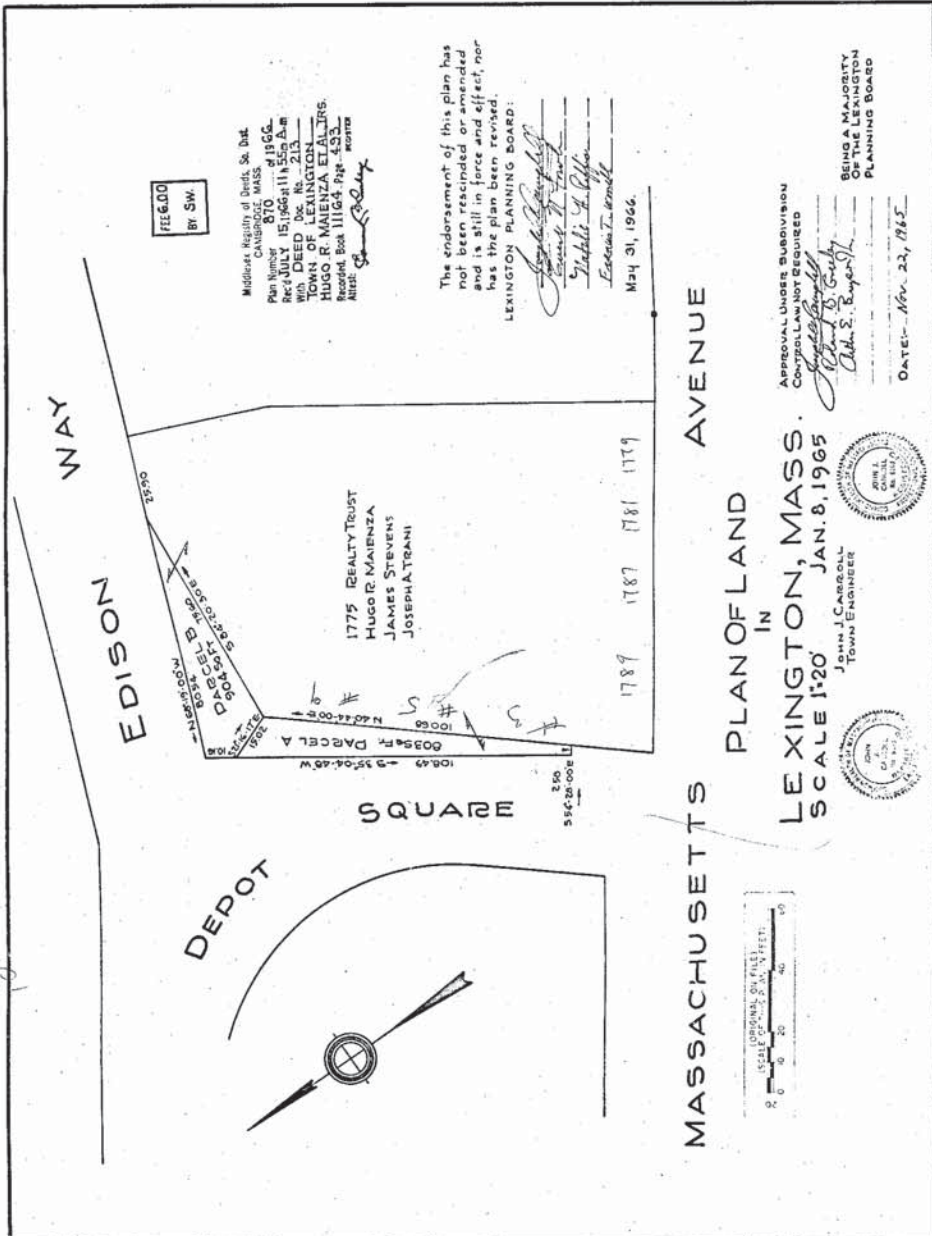

FEE \$100  
BY SW.

Middlesex Register of Deeds, Se. Dist.  
Middlesex, Massachusetts  
Plan Number 870 of 1966.  
Recd JULY 15, 1966 at 11:55am A.M.  
With DEED Doc. No. 213  
TOWN OF LEXINGTON  
HUGO R. MAHER, REGISTRAR  
Municipal Box 11164, Pitts-  
borough, Mass.

The endorsement of this plan has  
not been rescinded or amended  
and is still in force and effect, nor  
has the plan been revised.  
LEXINGTON PLANNING BOARD:

*[Signature]*  
Mayor  
*[Signature]*  
Alderman  
*[Signature]*  
Alderman  
May 31, 1966.

MASSACHUSETTS  
PLAN OF LAND  
IN  
LEXINGTON, MASS.  
SCALE 1"=20'  
JAN. 8, 1965

APPROVAL UNDER SUBDIVISION  
CONTROL LAW NOT REQUIRED  
*[Signature]*  
John J. Carroll  
Town Engineer

BEING A MAJORITY  
OF THE LEXINGTON  
PLANNING BOARD

DATE: Nov. 23, 1965



970