

Name- George E. Swanson

Service No. ~~26~~ 3056

Address 449 Waltham Street, Lexington

#5990

Location 22 Woodland Road

#6127

Kind of Pipe

Size

Size of Main

~~Repair - Renewal~~ - New Service

Location

Date	Material	Amount	Total	Date	Location	Amount
P. 4-10-28 for	37' 1" C.L. Pipe @ .27	9 99				
5-22-28 for	2 1" D.L. Coup. @ .25	50		April 3 1928 - Cash		30 00
4.51	1 1" L.L. Ell	30		Nov. 24 1928 - Cash		4 51
	1 1" Br. Sp. Nipple	25		7-23-'51	Renewal	
	1 S & W	3 00		26'	Copper	
	Trucking	75	14 79	Apr 8-25-28	1 3/4" C. Adapter	
				Apr. 11-15-28	1 3/4" C. X 3/4" C. Curb Cock	
4/13/29	Hrs. Labor @ .55	15 95		1	Box + Rod	
28	2 " " @ .60	1 20	17 15			
	15% Overhead		2 57			
			34 51			
1/26/83	Labor					
	RENEWED BY REDMOND #4156					
	37' 3/4" Copper tubing					

Hadley Press, Inc., Lexington

DATE April 3, 1928.

TOWN OF LEXINGTON—BOARD OF PUBLIC WORKS

WATER DIVISION

The undersigned applies for a supply of water at No. <sup>22</sup>~~38~~ Woodland Road St. <sup>next to Sawyers</sup> and hereby agrees to comply with the rules and regulations as now, or at any future time, established by the Board of Selectmen.

Am't. of Estimate \$ \_\_\_\_\_

Owner George E. Swanson

Am't. Paid \$ 30<sup>00</sup>

Address 449 Waltham St.

Builder \_\_\_\_\_

Lexington

Sketch of Service Here

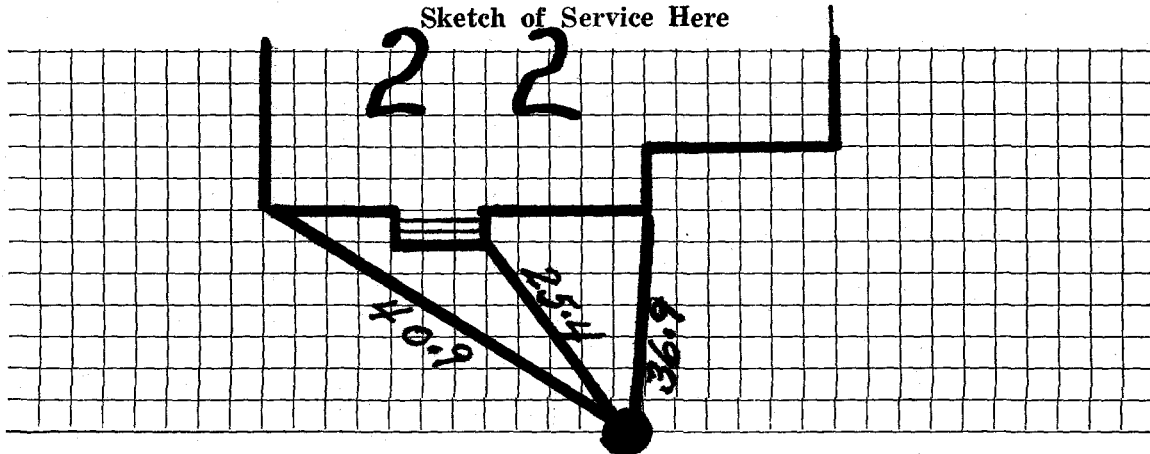

Connection made in \_\_\_\_\_ Street.

Work completed \_\_\_\_\_ 19

Remarks: