

WATER SERVICE RECORD

2351
Service No. 303

Name Emerson Realty Trust

Address 2 Whitman Circle

Location

~~REPAIRS~~ - New Service

Comm. 4-4-60

| Date | Material | Amount | Total | Date | Amount |
|---------|-------------------------|--------|-------|----------|---------------------------|
| 3-25-60 | Labor | 3 46 | | 11-19-59 | Deposit 100 00 |
| | 10% O.H. | 35 | 3 81 | 4-4-60 | Returned 54 95 |
| 77' | 3/4" Copper tubing@ .42 | | 32 34 | | 45 05 |
| 1 | 3/4" 1/2 IWH Stop&Waste | | 5 88 | | |
| 1 | 3/4" C3 Part Union | | 2 27 | | NON CHARGE |
| 1 | Hr. Trucking@ .75 | | 75 | | Labor |
| | | | 45 05 | 1 | 1/2 Straight tailpiece 50 |
| | | | | 1 | 1/2 Offset tailpiece 50 |
| | | | | | 1 00 |

TOWN OF LEXINGTON — BOARD OF PUBLIC WORKS

WATER DIVISION

Sketch of Service Here

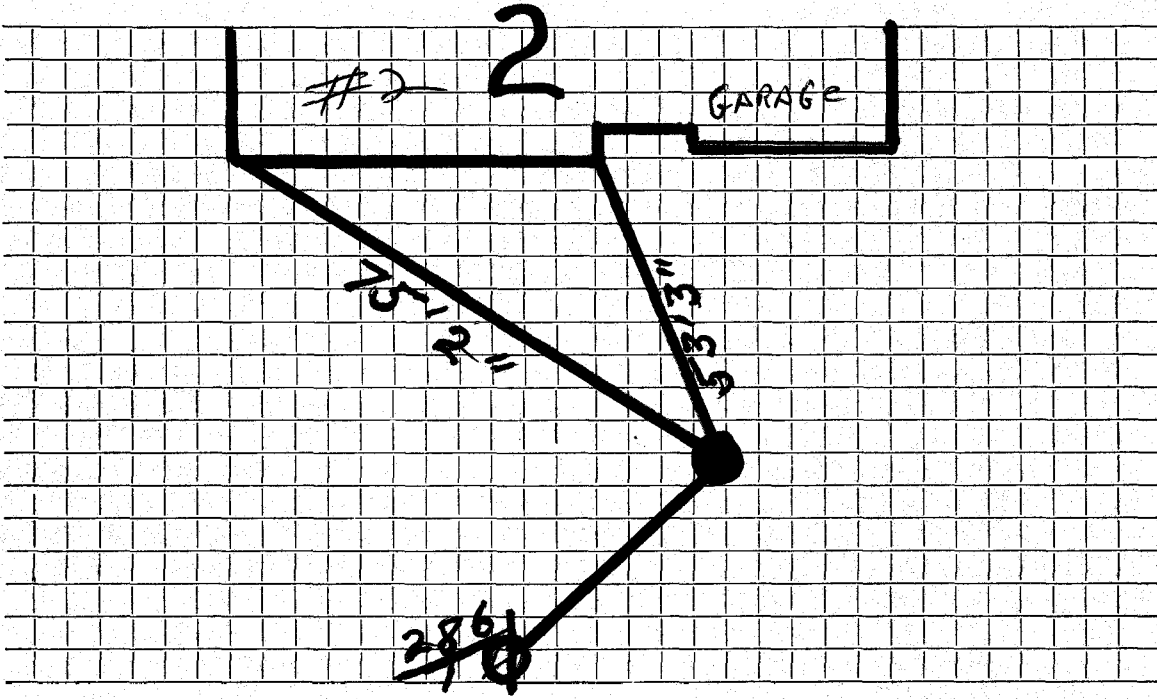

Connection made in Street. Work completed

Remarks:
.....
.....