

## WATER SERVICE RECORD

Name *Fine Homes Construction*

Service No.

Address *1 Trodden Path*

Location *Lot #12*

~~Repair - Renewal - New Service~~ *Redmond #3827*

Date	Material	Amount	Total	Date		Amount
<i>7/5/83</i>	<i>60.6" 1" Copper Tubing</i>					
	<i>1 1" Union</i>					
	<i>1" Wheel Valve</i>					
					<i>OUTSIDE</i>	
				<i>7/5/83</i>	<i>15.6" 1" Copper tubing</i>	
					<i>1 1" Corporation</i>	
					<i>1 1" Curb Stop</i>	
					<i>1 Box &amp; Rod</i>	

DATE 7-16-81

TOWN OF LEXINGTON — BOARD OF PUBLIC WORKS

WATER DIVISION

Sketch of Service Here

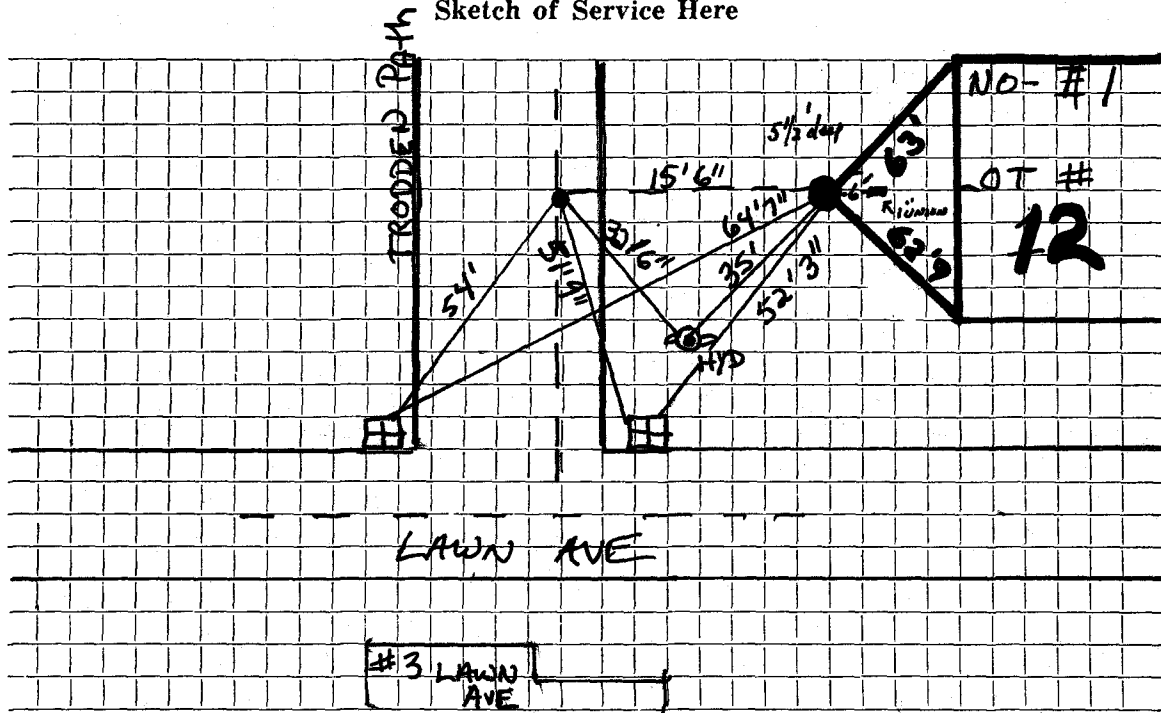

Connection made in ..... Street. Work completed .....

Remarks: 15'6" - 1" COPPER .....

.....  
.....