

TOWN OF LEXINGTON — BOARD OF PUBLIC WORKS

WATER DIVISION

Sketch of Service Here *LEXINGTON ST*

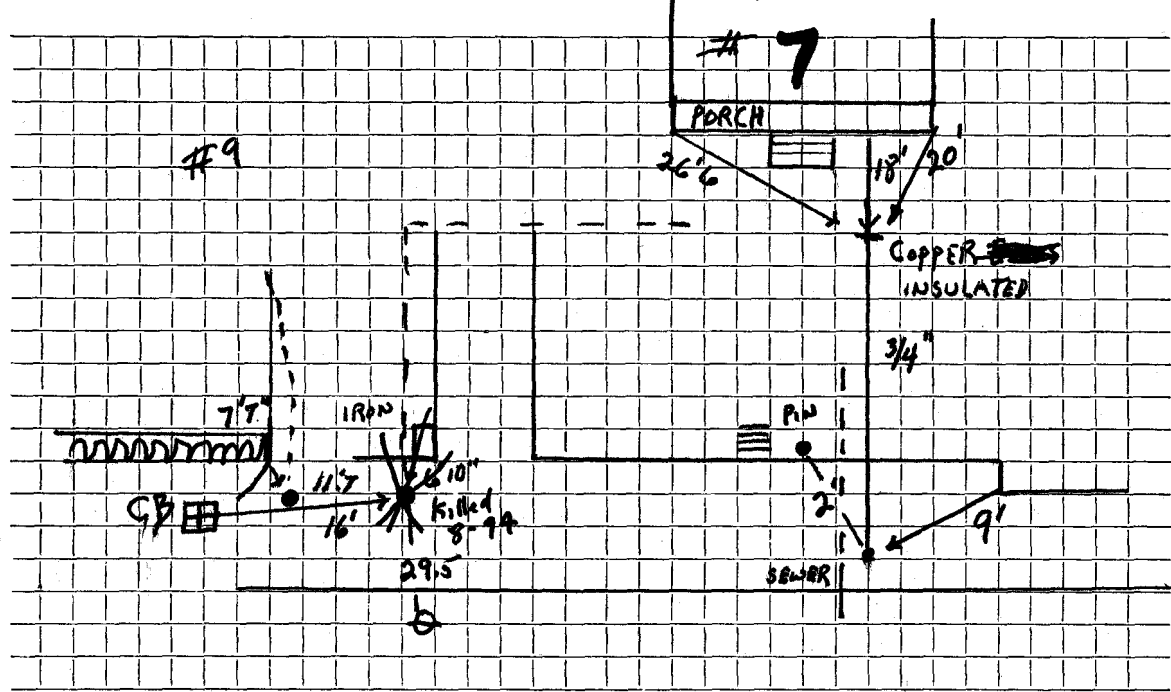

Connection made in Street. Work completed

Remarks: WATER IS TO RIGHT OF SEWER FACING HOUSE DOWN 38" Sewer 33" (WATER NOT CONNECTED TO MAIN)