

WATER SERVICE RECORD

Name Virginia Coleman

Service No. 27

Address 50 Percy Road

Location

~~Water Main~~ Renewal - ~~Water Service~~ W.O. #4766 Water Main Renewal

MAR 18 1968

| Date    | Material                           | Amount       | Total  | Date    |                           | Amount |
|---------|------------------------------------|--------------|--------|---------|---------------------------|--------|
| 6/14/67 | Labor                              | 60.05        |        | 6/12/67 | Labor                     | 96.08  |
| 6/15/67 | Labor                              | <u>60.05</u> |        | 6/13/67 | Labor                     | 96.08  |
|         | 10% O.H.                           | <u>12 02</u> | 132 11 | 6/22/67 | Labor                     | 47.48  |
|         |                                    |              |        | 7/6/67  | Labor                     | 11.79  |
| 80'     | 1 1/2" Copper Tubing @1.55         |              | 124 00 | 8'      | 1 1/2" Copper Tubing@1.55 | 12 40  |
| 1       | 1 1/2"-3 Part Union                |              | 9 56   | 170'    | 1 1/2" Copper Tub. @1.55  | 263 00 |
| 1       | 1 1/2" Wheel Valve                 |              | 9 70   | 3       | 1 1/2"-3 Pt. Unions @9.56 | 28 68  |
| 1       | 1 1/2" Curb                        |              | 33 94  | 1       | 6" x 1 1/2" Ser. Saddle   | 10 43  |
| 1       | 1 1/2" Bushing                     |              | 3 35   | 10      | Hrs. Tractor @6.50        | 65 00  |
| 1       | Hr. Tractor                        |              | 6 50   | 4       | Hrs. Loader @ 4.00        | 16 00  |
| 1       | Hr. Loader                         |              | 4 00   | 5       | Hrs. Trucking @3.00       | 15 00  |
| 1       | Hr. Truck                          |              | 3 00   | 1       | Ton Hot Top               | 5 80   |
|         |                                    |              |        | 1/2     | Hr. Roller @ 3.00         | 1 50   |
|         | Driveway Repair<br>(Bit. Concrete) |              | 150 00 | 500     | Lbs. Cold Patch           | 1 25   |
|         |                                    |              | 476 16 | 5       | Lbs. Grass Seed           | 5 50   |
|         |                                    |              |        |         |                           | 675 99 |
|         |                                    |              |        | 6-6-67  | Deposit                   | 700.00 |
|         |                                    |              |        | 3-18-68 | Refund                    | 223.84 |
|         |                                    |              |        |         |                           | 476.16 |
|         |                                    |              |        |         |                           | 675 99 |

DATE \_\_\_\_\_

# TOWN OF LEXINGTON — BOARD OF PUBLIC WORKS

## WATER DIVISION

Sketch of Service Here

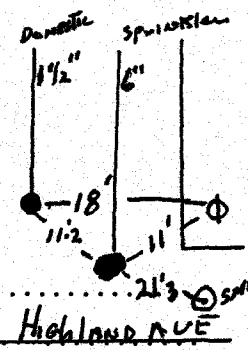
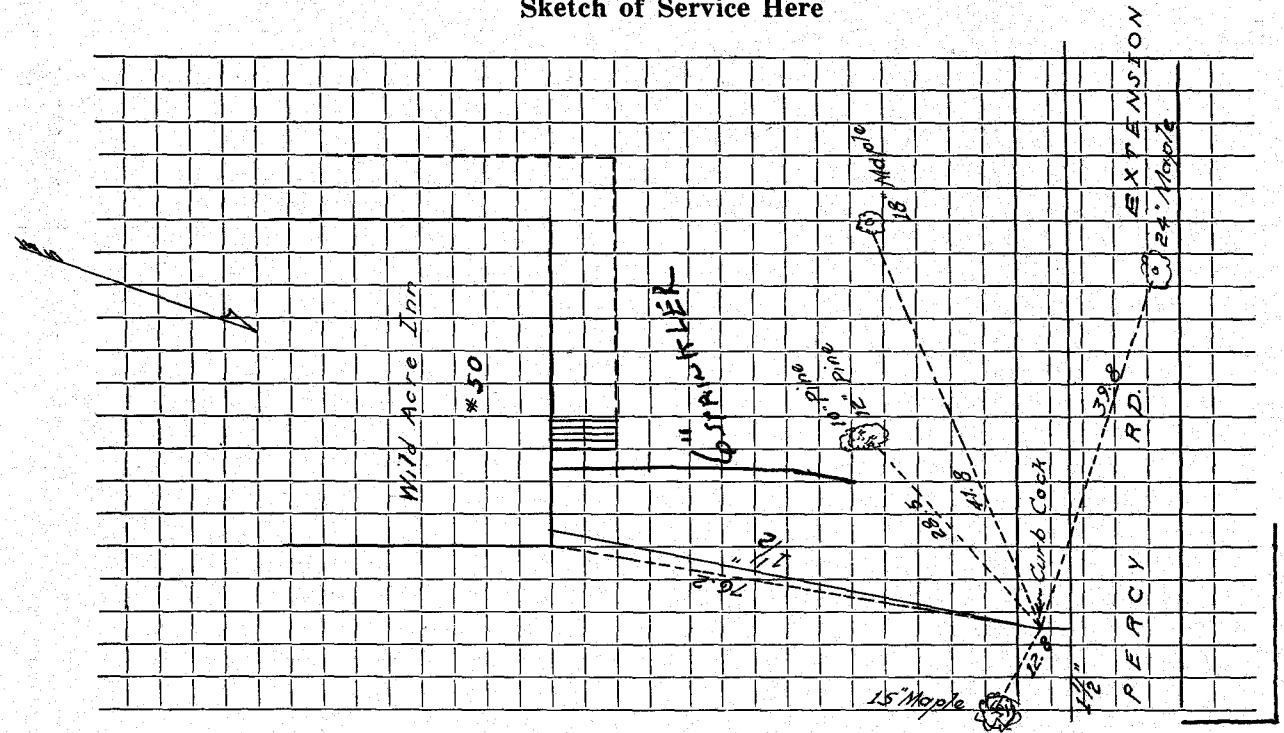

Connection made in ..... Street. Work completed .....

Remarks: .....  
.....  
.....

Highland Ave