

Name J. A. Bean

Service No. 181

Address 26 Parker Street

Location 26 Parker Street

Kind of Pipe

Size

Size of Main

~~XXXXXXXXXXXX~~ ^{General} ~~New Service~~

Com 12/31/47

Location

Date	Material	Amount	Total	Date	Amount
12/8/47	Labor	4 85	4 85	12/8/47	35 00
	10% Overhead	43	49	12/31/47	1 08
	36' 3/4" C. Tubing @ .26		9 36		33 92
	1 3/4" Cx3/4" I.W.H. S&W		3 15		Non-Charge
	1 3/4" Cx3/4" C. Union (3 pts.)		1 32	12/8/47	Labor 3 90
	2 hrs. Hired Shovel @ 7.00		14 00		12' 3/4" Copper tubing 3 12
	1 hr. Trucking		75		1 3/4" C. Corp. Cock 3 00
			33 92		1 3/4" Cx3/4" C. curb. cock 3 68
					1 1/2" Straight Tailpiece 30
					1 1/2" Offset Tailpiece 30
					1 hr. Hired Shovel @ 7.00 7 00
					1 hr. trucking 75
	Labor				Patching 8x3 8 00
					30 05

TOWN OF LEXINGTON – BOARD OF PUBLIC WORKS

WATER DIVISION

The undersigned applies for a supply of water at No..... St. and hereby agrees to comply with the rules and regulations as now, or at any future time, established by the Board of Selectmen.

Am't of Estimate \$.....

Owner

Am't Paid \$.....

Address

Builder

.....

Sketch of Service Here

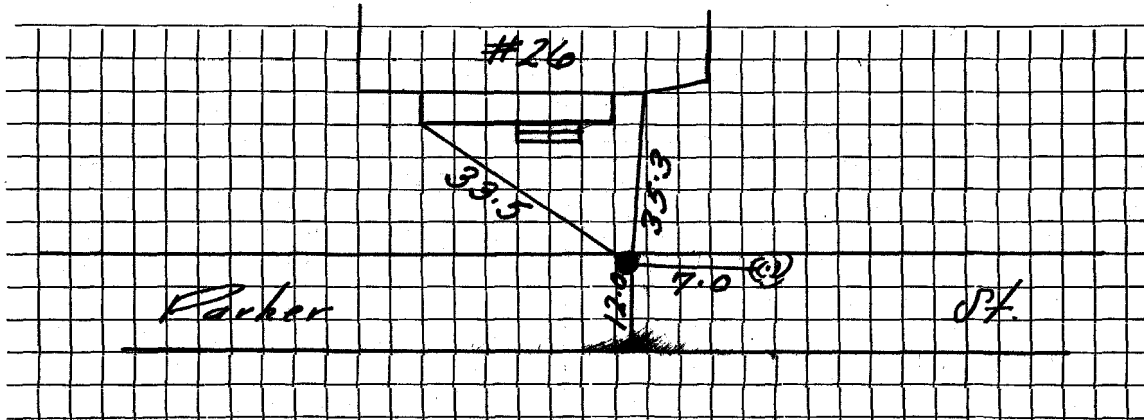

Connection made in Street.

Work completed19

Remarks: