

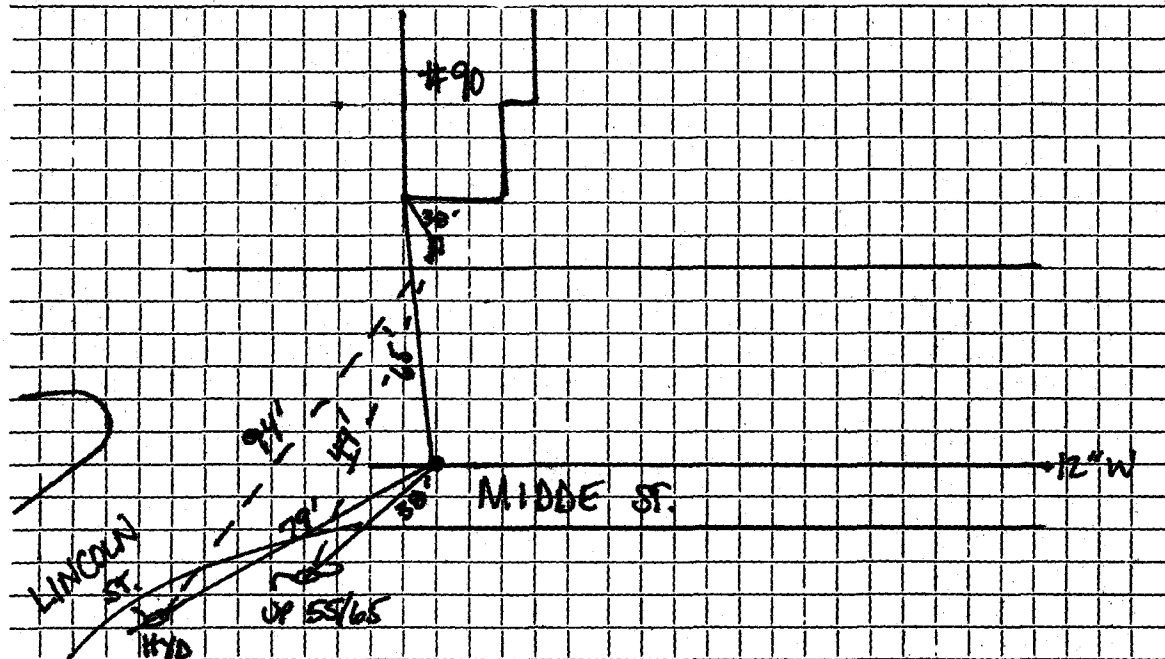

DATE 8-4-1999

TOWN OF LEXINGTON — BOARD OF PUBLIC WORKS  
WATER DIVISION

Sketch of Service Here



Connection made in 12" MAIN ON MIDDLE ST. .... Street. Work completed NEW CONNECTION, UNION .....

Remarks: TWO CURB BORES FOR #90 HSE, 1 IN DRIVEWAY IS DEAD, OTHER IS IN FRONT YARD PERPENDICULAR TO  
LEFT CORNER OF HOUSE.



