

Name : Wright-Thomas
 Address : 241 Grove Street
 Lexington, Mass.

2987
 # 2988

Service No.

232

Location

Kind of Pipe

Size

Size of Main

~~Repairs~~ ~~Renewal~~ - New Service

Com. 2-21-49

Location

Date	Material	Amount	Total	Date	Amount
Oct. 5, '48	Labor	2 30	2 30	Oct. 5, '48	15 00
	10% Overhead		23	Sub 21 '49	9 57
	Used old servie from well				5 43
	1-1 1/4" x 1" Reducing Coupling		79	Oct. 5, '48 Labor	39 13
	1-1 1/4" Close Nipple (Brass)		50	19'-1" Copper Tubing	5 89
	1-1" Close Nipple (Brass)		46	1-1" C. Corp-cock	4 42
	1-1" x 3/4" Bushing		40	1-1" C x 1" I. Curb-cock	5 36
	1 hr. Trucking		75	1-1 1/4" x 1" Reducing Coupling	79
			5 43	1-1 1/4" Nipple (Brass) 4" Long	50
				1-1" Close Nipple (Brass)	46
				1-1 1/4" Repair Clamp	1 53
				1 hr. Trucking	75
	Labor			1 Box & Rod	3 55
					62 38

DATE _____

TOWN OF LEXINGTON - BOARD OF PUBLIC WORKS

WATER DIVISION

The undersigned applies for a supply of water at No..... St. and hereby agrees to comply with the rules and regulations as now, or at any future time, established by the Board of Selectmen.

Am't of Estimate \$.....

Owner

Am't Paid \$.....

Address

Builder

.....

Sketch of Service Here

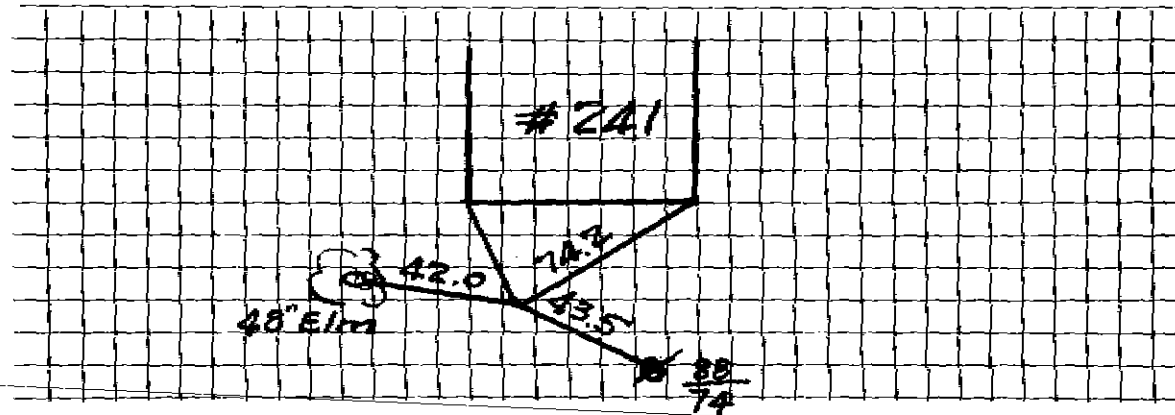

Connection made in Street.

Work completed19

Remarks: