

Name John Bates

Service No. 103

Address 224 Gollen Road
Lexington, Mass.

Location 224 Gollen Road

Kind of Pipe

Size

Size of Main

~~Repair~~ ~~Renewal~~ ~~New Service~~

Location

Date	Material	Amount	Total	Date	Amount
Jul. 26, '48	Labor	12 30	12 30	July 28 '48	90 00
	10% Overhead		1 23	Oct. 28 '48	32 74
	51' - 3/4" Copper tubing @.255	13 01			<u>67 26</u>
	1 - 3/4" C x 1/2" I.P.E. S & W	3 15		Jul. 26, '48	18 30
	1 - 3/4" C x 3/4" C Union (pts)	1 32		35' - 3/4" Copper tubing @.255	8 67
	Littlefield shovel 1 1/2 hrs	7.00	10 50	1 - 3/4" C Curb-cock	3 00
	Trucking 1 hr.	.75	75	1 - 3/4" C x 3/4" C Curb-cock	3 58
	Watching 2 1/2 x 3		<u>25 00</u>	1 - Box w Red	3 55
			67 26	1 - 1/2" Straight Nail Piece	30
				1 - 3/4" Offset Nail Piece	30
				shovel 2 hrs.	14 00
				Trucking 1 hr.	75
					<u>52 55</u>

Deposited
Refunded
Non-Charge

Call 10/25/48

Labor

Hadley Press, Inc., Lexington

DATE _____

TOWN OF LEXINGTON—BOARD OF PUBLIC WORKS

WATER DIVISION

The undersigned applies for a supply of water at No. _____ St. and hereby agrees to comply with the rules and regulations as now, or at any future time, established by the Board of Selectmen.

Am't. of Estimate \$ _____

Owner _____

Am't. Paid \$ _____

Address _____

Builder _____

Sketch of Service Here

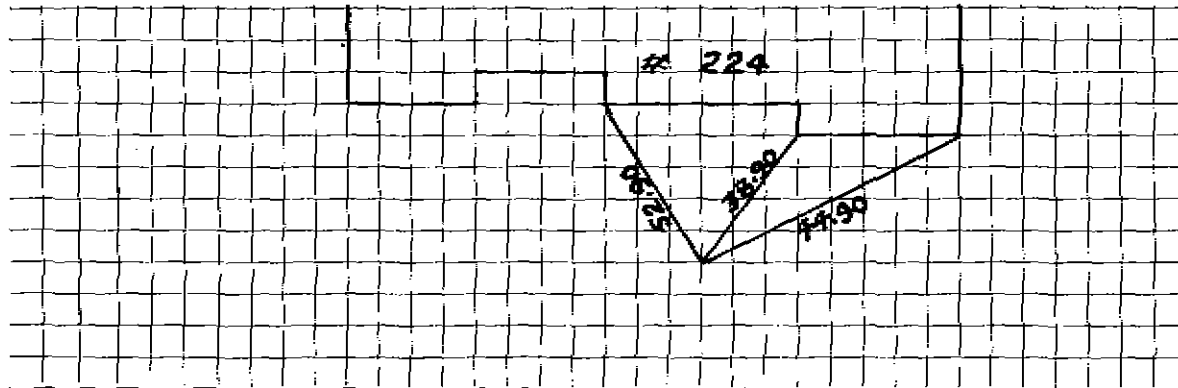

Connection made in _____ Street. Work completed _____ 19 _____

Remarks:

Name John Bates

Service No.

103

Address 224 Follen Road

Lexington, Mass.

Location 224 Follen Road

Kind of Pipe

Size

Size of Main

~~Repair~~ ~~Renewal~~ ~~New Service~~

Location

Date

Material

Amount

Total

Date

Amount

Jul. 26, '48

Labor

12 30

12 30

10% Overhead

1 23

51' - 3/4" Copper Tubing @ .255

13 01

1 - 3/4" C x 1/2" I.W.H. S & W

3 15

1 - 3/4" C x 3/4" C Union (pts)

1 32

Littlefield Shovel 1 1/2 hrs @ 7.00

10 50

Trucking 1 hr. @ .75

75

Patching 25 x 3

25 00

67 26

July 13 '48 *Disputed*
July 28 '48 *Refrused*
Non-Charge

90 00

22 74

67 26

Jul. 26, '48 Labor

18 30

34' - 3/4" Copper Tubing @ .255

8 67

1 - 3/4" C Corp-cock

3 00

1 - 3/4" C x 3/4" C Curb-cock

3 68

1 - Box & Rod

3 55

1 - 1/2" Straight Tail Piece

30

1 - 1/2" Offset Tail Piece

30

Shovel 2 hrs. @ 7.00

14 00

Trucking 1 hr. @ .75

75

52 55

Labor

Com. 10/25/48

Hadley Pumps, Inc., Lexington

DATE _____

TOWN OF LEXINGTON—BOARD OF PUBLIC WORKS

WATER DIVISION

The undersigned applies for a supply of water at No. _____ St. and hereby agrees to comply with the rules and regulations as now, or at any future time, established by the Board of Selectmen.

Am't. of Estimate \$ _____

Owner _____

Am't. Paid \$ _____

Address _____

Builder _____

Sketch of Service Here

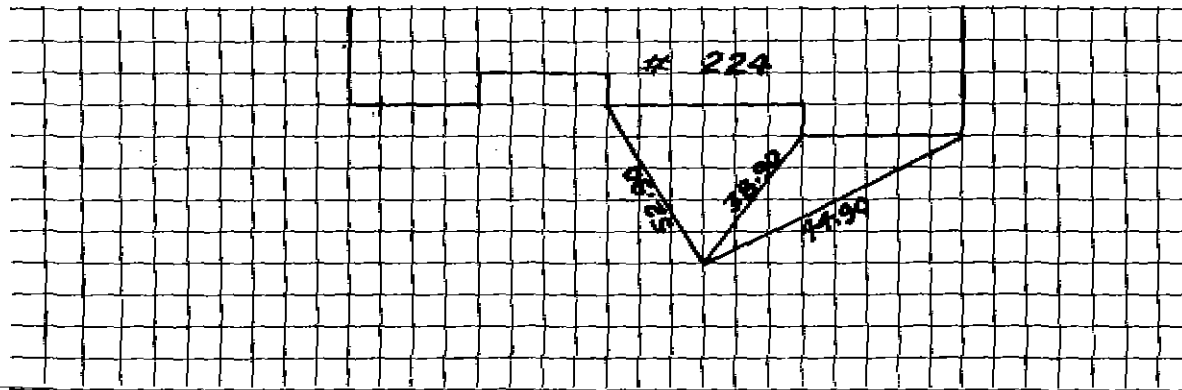

Connection made in _____ Street. Work completed _____ 19

Remarks: