

**Water Service Tie Card**  
**TOWN OF LEXINGTON**  
 MASSACHUSETTS

**121 East Emerson Road**

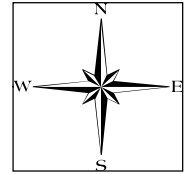
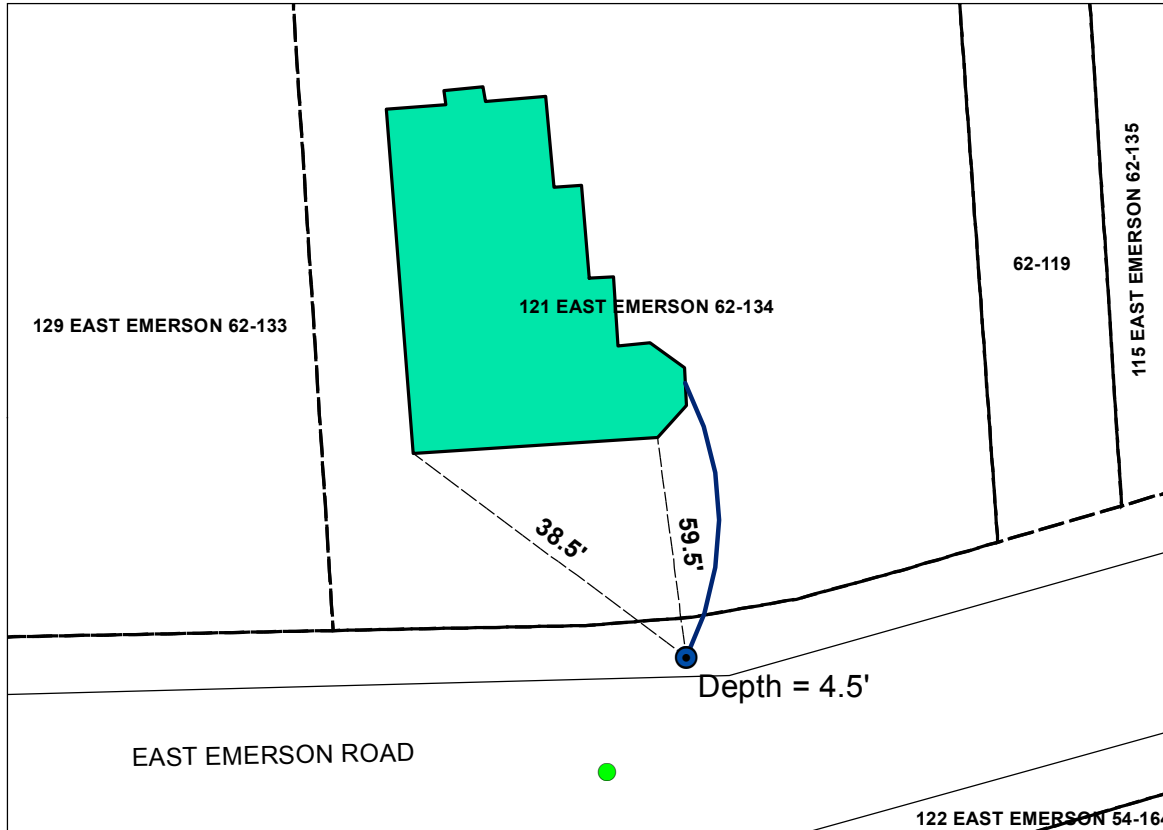

Legend	
<span style="color: blue;">●</span>	Curb Stop
---	Ties_Dimensions
<span style="color: blue;">—</span>	Water Service Line
---	Property Line
---	Edge of Pavement
	CATCH BASIN

Address	Map and Lot	Permit Number	Contractor Name	Inspector
121 East Emerson	62-134	5607	Tocci, Sean S. Excavating, Inc.	dpavlik
Date	Material	Depth of Cover	Amount	
4/25/2014	3/4" Copper type "k"	4.5 ft	6"	
	3/4" to 1" fitting	4.5 ft	1	
	1" Copper type "k"	4.5 ft	1	
	1" Curb Valve and Buffalo Box	4.5 ft	38 feet to house	
Type of work completed				

New 1" water service to house from curb stop. New house on lot old house removed.