

DATE _____

TOWN OF LEXINGTON — BOARD OF PUBLIC WORKS

WATER DIVISION

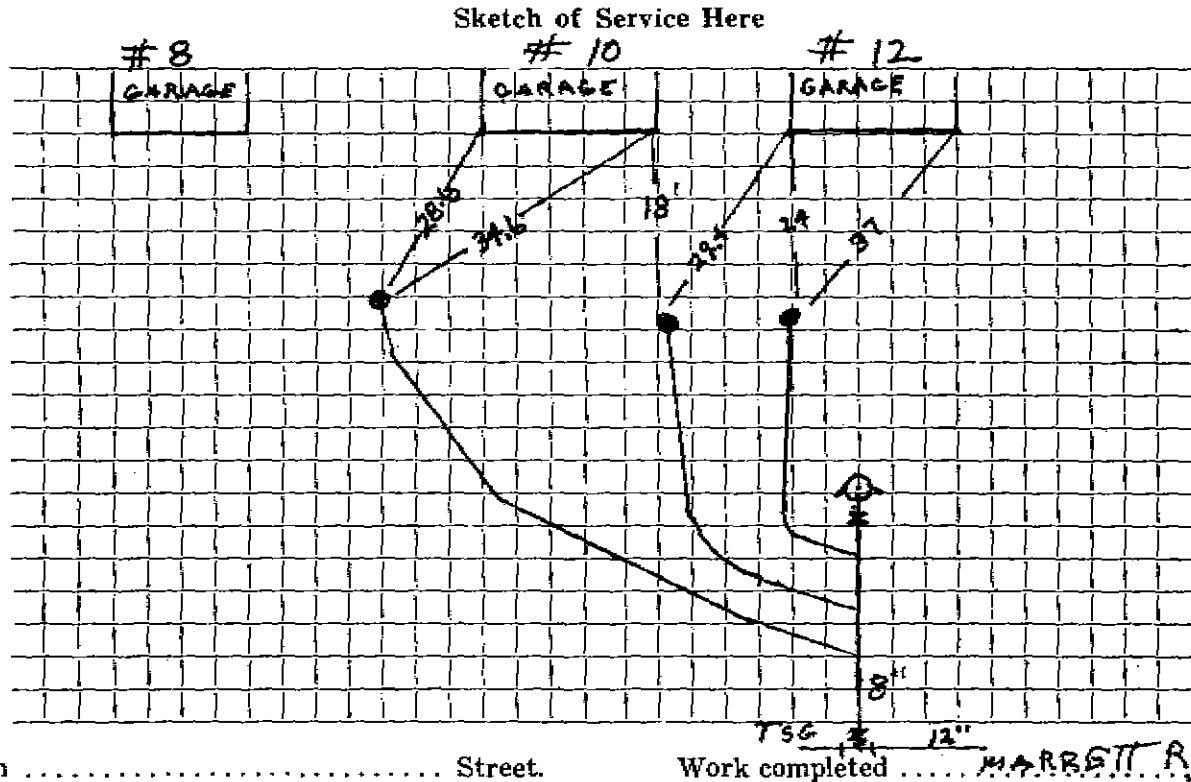

Connection made in Street. Work completed MARBETT RD

Remarks:

.....

.....

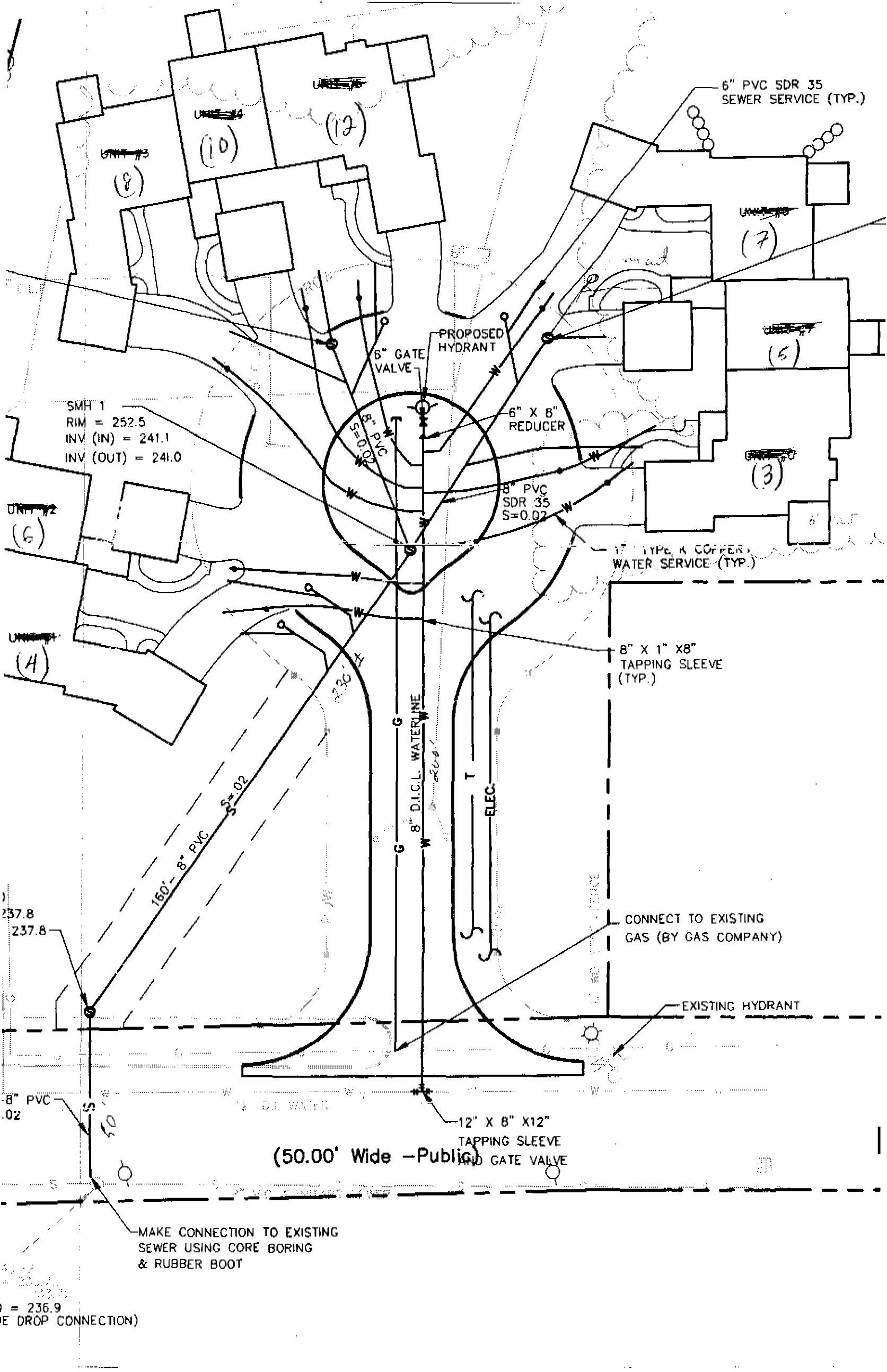

6" PVC SDR 35
SEWER SERVICE (TYP.)

UNIT #3

(10) (12)

UNIT #8

(7)

(5)

(3)

SMH 1
RIM = 252.5
INV (IN) = 241.1
INV (OUT) = 241.0

PROPOSED
HYDRANT

6" GATE
VALVE

6" X 8"
REDUCER

8" PVC
SDR 35
S=0.02

1" TYPE K COPPER,
WATER SERVICE (TYP.)

8" X 1" X 8"
TAPPING SLEEVE
(TYP.)

8" D.I.C.L. WATERLINE

ELEC.

CONNECT TO EXISTING
GAS (BY GAS COMPANY)

EXISTING HYDRANT

(50.00' Wide - Public)

12" X 8" X 12"
TAPPING SLEEVE
AND GATE VALVE

MAKE CONNECTION TO EXISTING
SEWER USING CORE BORING
& RUBBER BOOT

= 236.9
(DROP CONNECTION)

TOWN OF LEXINGTON—BOARD OF PUBLIC WORKS
WATER DIVISION

The undersigned applies for a supply of water at No. _____ St. and hereby agrees to comply with the rules and regulations as now, or at any future time, established by the Board of Selectmen.

Am't. of Estimate \$ _____

Owner

D. Collins

Am't. Paid \$ _____

Address

4 Cottage St.

Builder _____

Sketch of Service Here

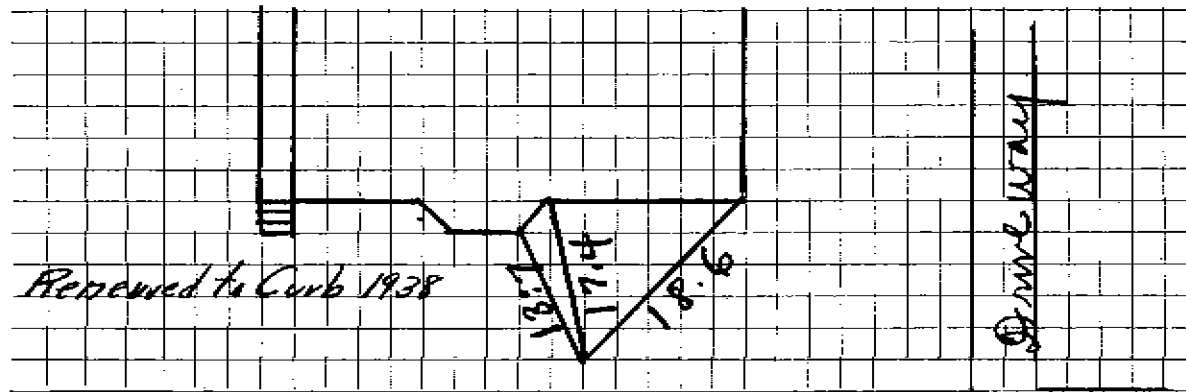
Connection made in Cottage St Street.

Work completed _____ 19

Remarks: