

WATER SERVICE RECORD

4838

Name Moore Construction Co.

Service No. 138

Address 16 Concord Avenue

Location

~~Repair & Renewal~~ - New Service

Comm. 8-30-54

Date	Material	Amount	Total	Date	Amount
6/28/54	Labor	6 90		6-15-54	Deposited 100 00
7/2/54	" 10% overhead	6 90	13 80	9-3-54	Paid 6 40
	105' 3/4" copper tubing @ .35		36 75		<u>NON CHARGE</u> 106 40
	1 - 3/4" C x 1/8 I.W.H. stop & waste		4 00	7/2/54	Labor 16 10
	1 - 3/4" C. union		1 72	27' - 3/4" copper tubing @ .35	9 45
	4 hrs. Littlefield shovel @ 7.50		30 00	1 - 3/4" c. corp-cock	4 33
	1 hr. trucking		75	1 - 3/4" c. curb-cock	4 67
	patching 18x3		18 00	1 box and rod	3 90
			106 40	1 - 1/2 offset tail piece	50
				1 - 1/2 straight tail piece	50
				4 2/3 hrs. Littlefield shovel @ 7.50 - 35.00	
				1 hr. trucking	75
					<u>75 20</u>

100 00 6 40 106 40

DATE _____

TOWN OF LEXINGTON - BOARD OF PUBLIC WORKS

WATER DIVISION

Sketch of Service Here

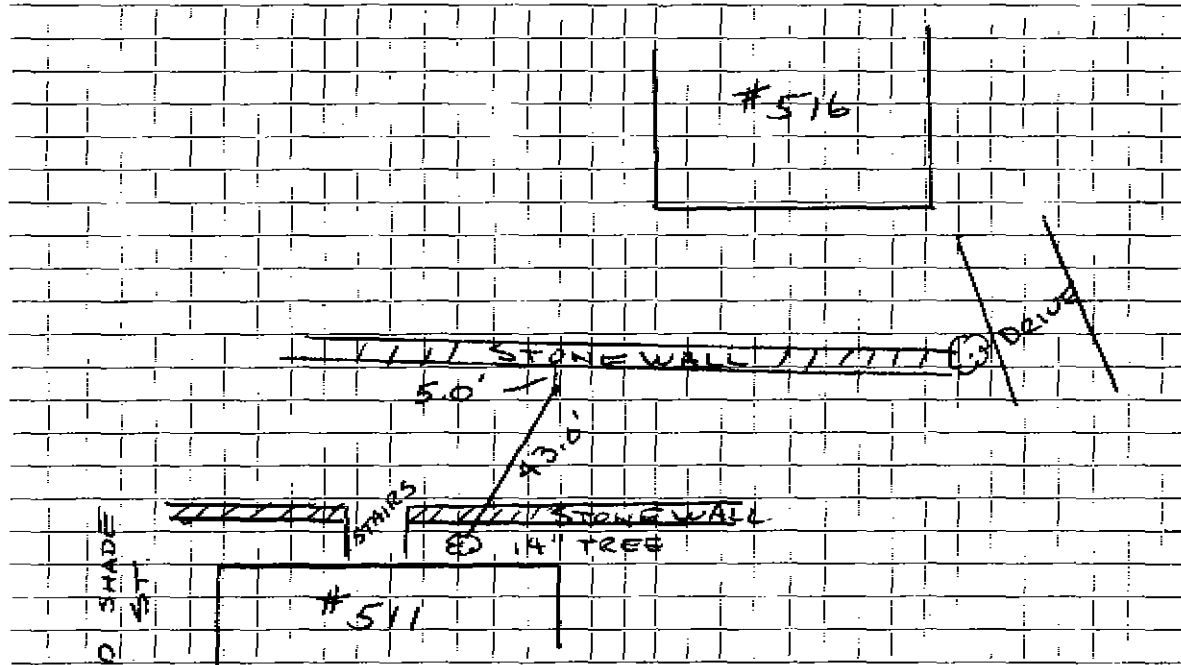

Connection made in Street. Work completed

Remarks:

.....

.....