

## WATER SERVICE RECORD

Name Frederick L. Yeomens

Service No. 351 (1955)

Address 485 Concord Avenue

# 3073

Location

Repair—Renewal—New Service

Comm 9-24-56

| Date    | Material                            | Amount | Total | Date                                     | Amount            |
|---------|-------------------------------------|--------|-------|--|-------------------|
| 1/10/56 | Labor                               | 3 80   |       | 11-3-55                                  | Deposit 75 00     |
|         | 10% overhead                        | 38     | 4 18  | 9-24-56                                  | Refund 25 11      |
|         | 35' 3/4" copper tubing @ .4850      | 16 98  |       |  | NON CHARGES 47 89 |
|         | 1 3/4" C x 1/2" I.W.H. stop & waste | 4 96   |       | Labor                                    | 3 80              |
|         | 1 3/4" C 3 part union               | 2 27   |       | <del>15 3/4" copper tubing @ .4850</del> | <del>7 28</del>   |
|         | 3 x 3 patching                      | 3 00   |       | <del>1 3/4" C Corp Cock</del>            | <del>4 34</del>   |
|         | 2 hrs. Littlefield @ 8.50           | 17 00  |       | <del>1 3/4" C Curb Cock</del>            | <del>5 94</del>   |
|         | 2 hrs. trucking @ .75               | 1 50   |       | <del>1 Box A Rod</del>                   | <del>4 62</del>   |
|         |                                     |        | 49 89 | <del>1 1/2 Straight tail piece</del>     | <del>50</del>     |
|         |                                     |        |       | <del>1 1/2 Offset tail piece</del>       | <del>50</del>     |
|         |                                     |        |       | <del>1 hr. trucking @ .75</del>          | <del>75</del>     |
|         |                                     |        |       | <del>1 hr. Littlefield @ 8.50</del>      | <del>8 50</del>   |
|         |                                     |        |       | Aug 02 29.5                              | 1" Copper 36 23   |
|         |                                     |        |       |  | 1 1" Corp         |
|         |                                     |        |       |  | 1 1" Curb STOP    |
|         |                                     |        |       |  | 1 1" x 3/4 Red    |
|         |                                     |        |       |  | buff-lo box       |

TOWN OF LEXINGTON — BOARD OF PUBLIC WORKS

WATER DIVISION

Sketch of Service Here  
CONCORD AVE

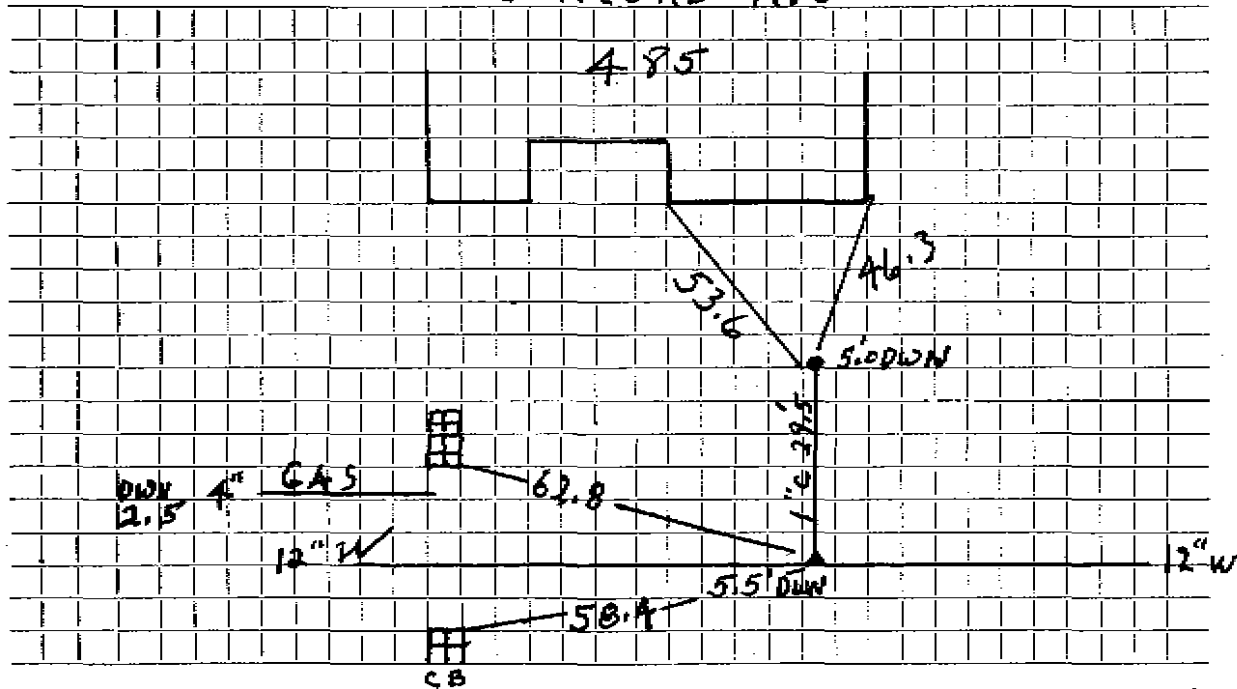

Connection made in \_\_\_\_\_ Street. Work completed AUG 2002 DEMI

Remarks: Ties from house MAY HAVE CHANGED