

Name

Address

Service No. 581 #5623

Location 15 Cliffe Ave.

Kind of Pipe

Size

Size of Main

Repair—Renewal—New Service

Location

Date

Material

Amount

Total

Date

Amount

Labor

3-5-57

Outside  
8'-3/4 Cap  
1-3/4 Curb  
1-3/4 Corp Adapt  
~~1-1x3/4~~  
1-Box

Hadley Press, Inc., Lexington

DATE \_\_\_\_\_

# TOWN OF LEXINGTON—BOARD OF PUBLIC WORKS

## WATER DIVISION

The undersigned applies for a supply of water at No. \_\_\_\_\_ St. and hereby agrees to comply with the rules and regulations as now, or at any future time, established by the Board of Selectmen.

Am't. of Estimate \$ \_\_\_\_\_

Owner

C. S. Hagar

Am't. Paid \$ \_\_\_\_\_

Address

15 ~~27~~ Cliff Lane

Builder \_\_\_\_\_

Sketch of Service Here

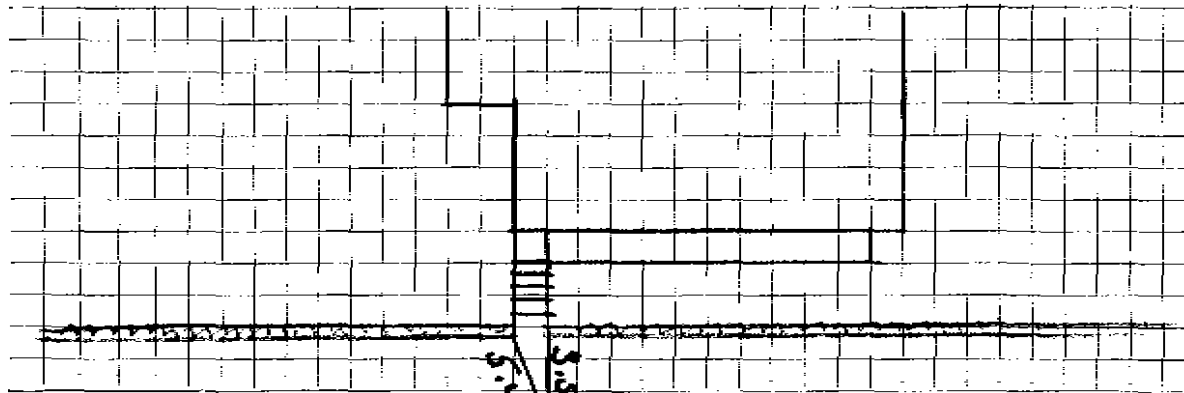

Connection made in \_\_\_\_\_

Street.

Work completed \_\_\_\_\_

19

Remarks:

33.4

Name Reuben Moore  
 Address 16 Cliffe Avenue  
 Lexington, Mass.

Service No. 113

# 3076

Location 16 Cliffe Avenue

Kind of Pipe	Size	Size of Main	Location		
<del>Repair</del> <del>Renovate</del> - New Service	Com. 7-3-50				
Date	Material	Amount	Total	Date	Amount
June 12, '50	Labor	1 30	1 30	May 15 '50	20 00
	10% Overhead		13	July 20 '50	
	35' - 3/4" Copper Tubing @.23	8 05	8 05	Deposited Returned No Charge	
	1 - 3/4" C x 1/2" I.W.H. S&W	3 29	3 29	June 12, '50	1 30
	Trucking 1 hr. @.75		75	22' - 3/4" Copper Tubing @.23	5 06
			13 52	1 - 3/4" C Corp-cock	3 15
				1 - 3/4" F x 3/4" C Curb-cock	3 85
				1 - Box & Rod	3 35
				1 - 1/2" Offset Tail Piece	38
				1 - 1/2" Straight Tail Piece	38
				Littlefield Shovel 1 hr. @ 7.00	7 00
				Trucking 1 hr. @.75	75
	Labor				25 22

DATE \_\_\_\_\_

TOWN OF LEXINGTON - BOARD OF PUBLIC WORKS

**WATER DIVISION**

The undersigned applies for a supply of water at No..... St. and hereby agrees to comply with the rules and regulations as now, or at any future time, established by the Board of Selectmen.

Am't of Estimate \$.....

Owner .....

Am't Paid \$.....

Address .....

Builder .....

.....

**Sketch of Service Here**

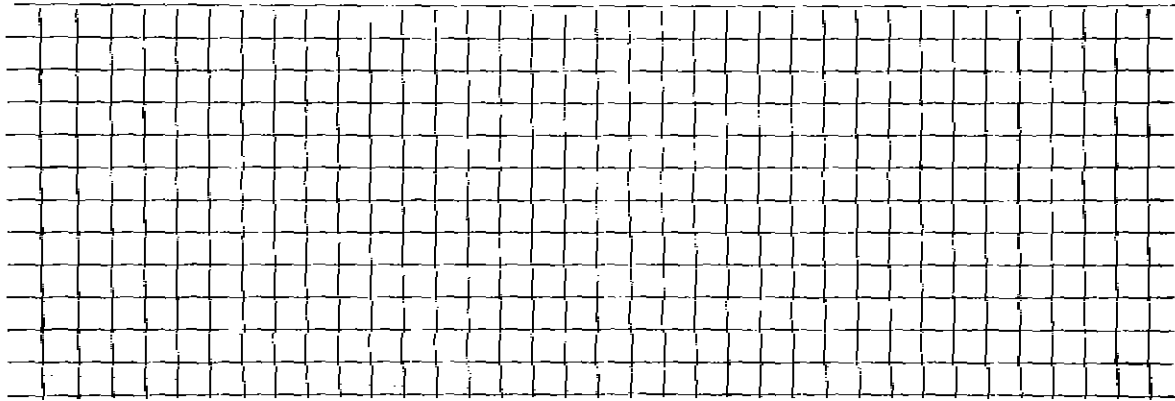

Connection made in ..... Street.

Work completed .....19

Remarks: