

Name Ingemann Neilsen.

1223

Service No.

123

3369

Address 166 Burlington Street

Location 166 Burlington Street

Kind of Pipe

Size

Size of Main

~~Repair~~ New Service

Location

Date	Material	Amount	Total	Date	Amount
Sept. 30, '47	Labor	1 10	1 10	Sept. 24 '47	45 00
	10% Overhead		11	Dec. 4 '47	3 03
	79' - 3/4" Copper Tubing @ .26	20 54	20 54		41 97
	1 - 3/4" C x 1/2" I.W.H. S & W	3 15	3 15	Sept. 30, '47	17 57
	1 - 3/4" C x 3/4" C U 3 pt	1 32	1 32	22' - 3/4" Copper Tubing @ .26	5 72
	Patching 15 x 3	15 00	15 00	1 - 3/4" C Corp-cock	3 00
	Trucking 1 hr. @ .75	75	75	1 - 3/4" C x 3/4" C Curb-cock	3 68
			41 97	1 - Box & Rod	4 26
				1 - 1/2" Offset Tail Piece	30
				1 - 1/8" Straight Tail Piece	30
				Trucking 1 hr. @ .75	75
					35 58
	Labor				

TOWN OF LEXINGTON - BOARD OF PUBLIC WORKS

WATER DIVISION

The undersigned applies for a supply of water at No..... St. and hereby agrees to comply with the rules and regulations as now, or at any future time, established by the Board of Selectmen.

Am't of Estimate \$.....

Owner

Am't Paid \$.....

Address

Builder

121 Maple St. Lexington

Sketch of Service Here

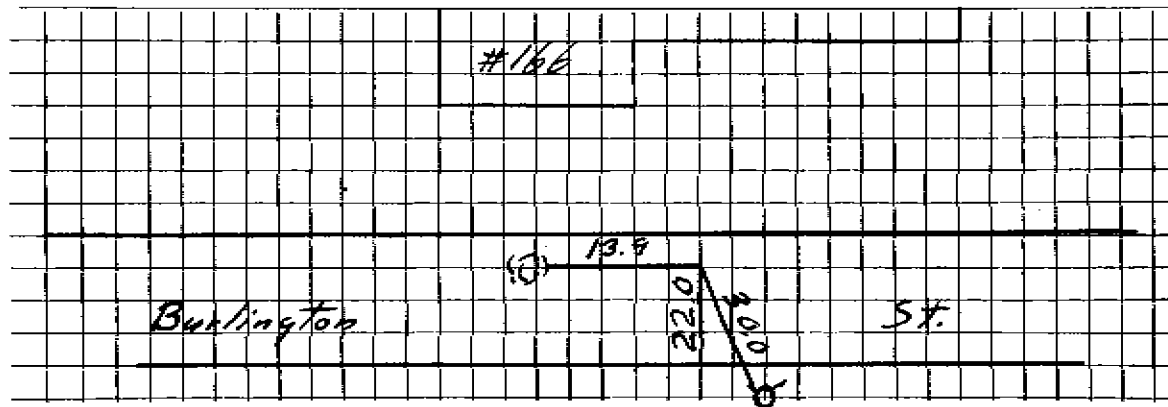

Connection made in Street.

Work completed19

Remarks: