

TOWN OF LEXINGTON — BOARD OF PUBLIC WORKS
WATER DIVISION

Sketch of Service Here

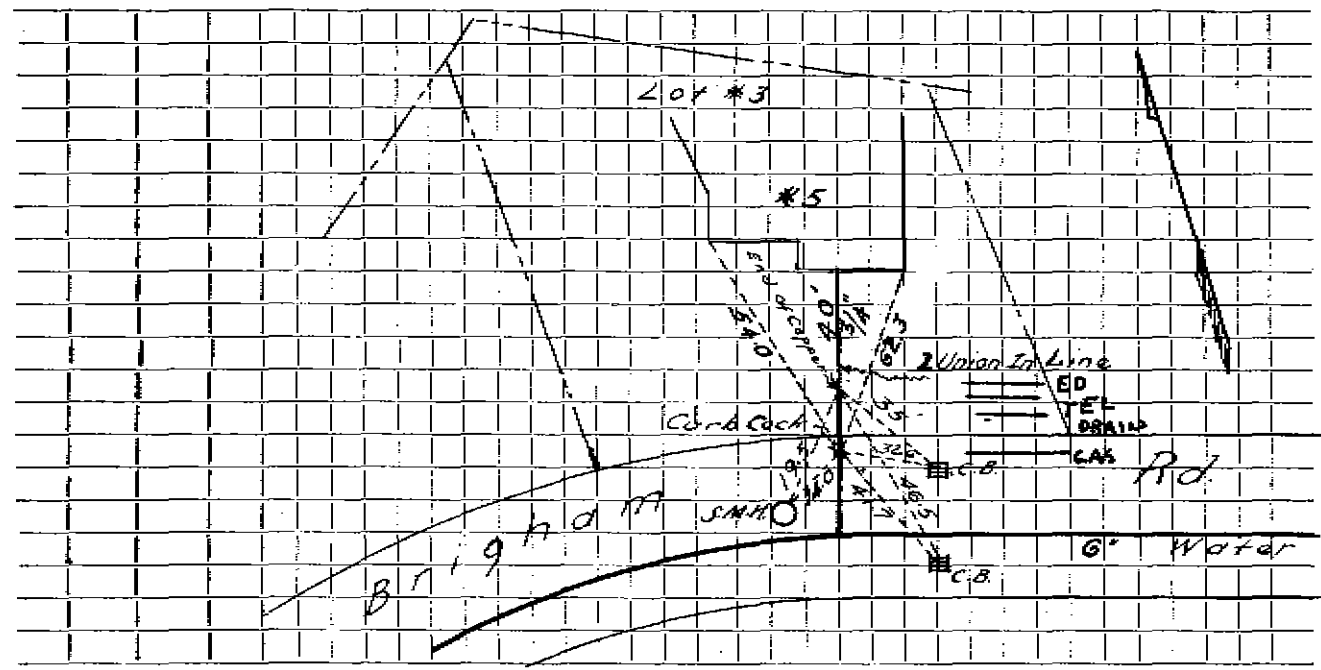

Connection made in _____ Street. Work completed _____

Remarks: GAS 3' FROM EDGE OF RD, CURB BOX AGAINST FRONT OF DRAIN, TEL + 2 ED. LINES (Dist. 3' 8"). 2 UNION'S JUST BEYOND
 ELECTRICAL LINES 5'-7" FROM CURB BOX DOWN 5'-6"