

DATE _____

TOWN OF LEXINGTON — BOARD OF PUBLIC WORKS

WATER DIVISION

Sketch of Service Here

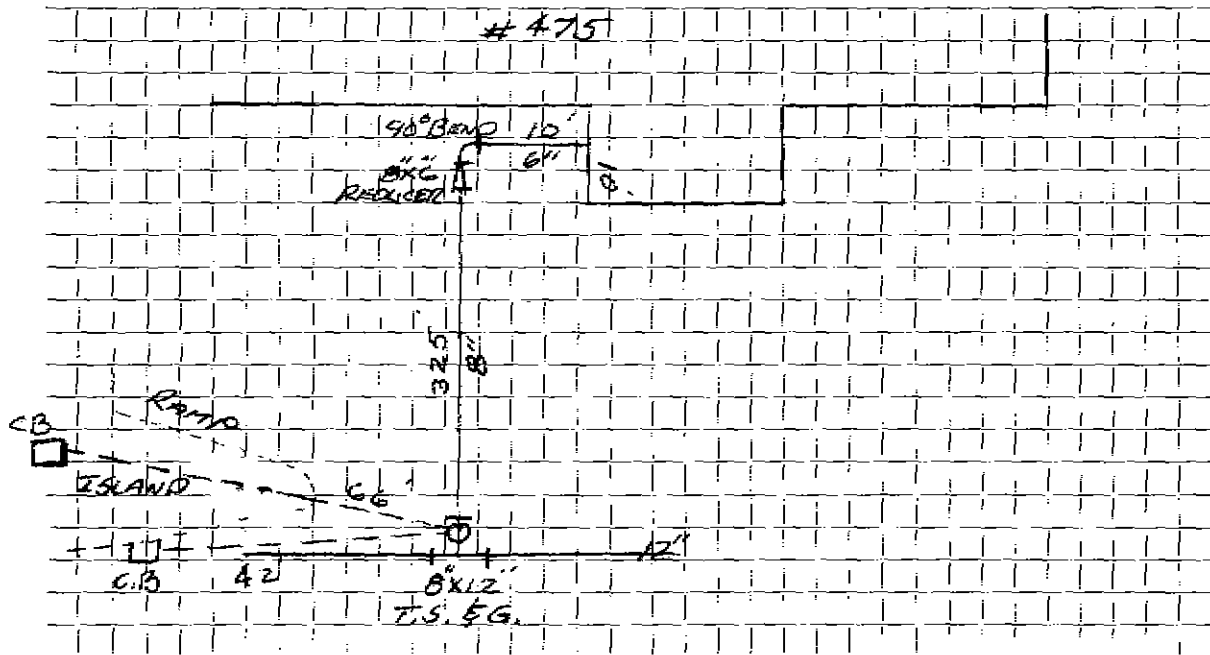

Connection made in BEDFORD Street. Work completed

Remarks:

DATE _____

TOWN OF LEXINGTON — BOARD OF PUBLIC WORKS
WATER DIVISION

Sketch of Service Here

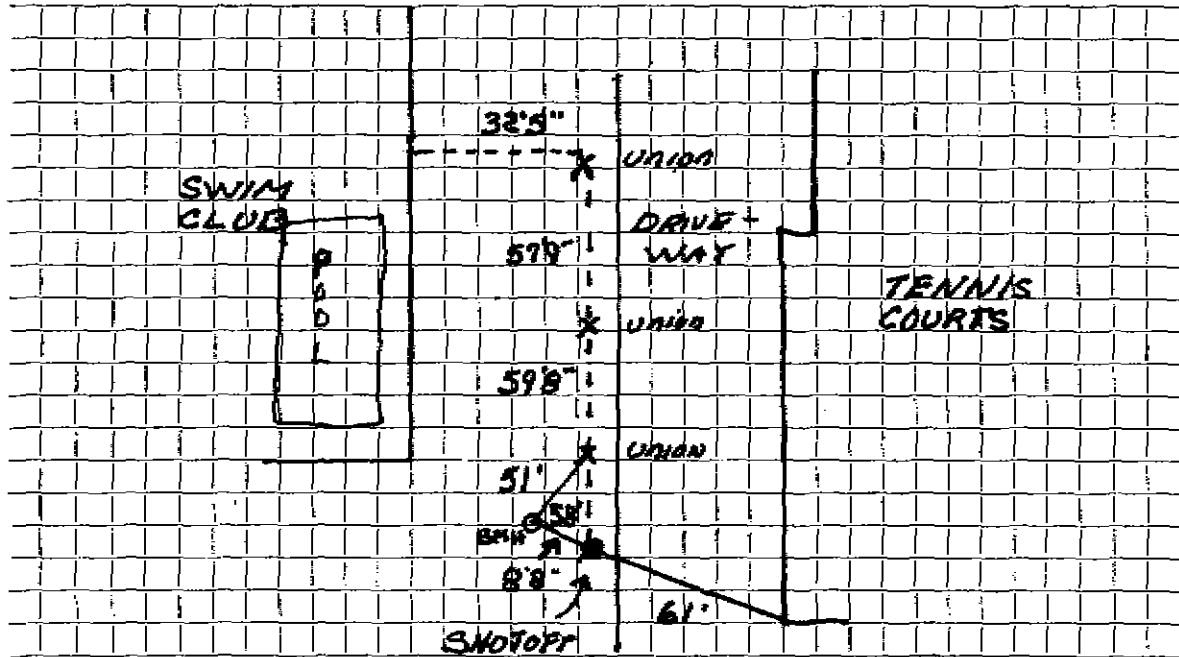

Connection made in _____ Street. Work completed _____

Remarks: NEW Line 1/2" copper tied into 1 1/2" CL Pipe _____

.. Old Shut off at P.t. Side walk _____ BEDFORD ST. _____

WATER SERVICE RECORD

Name **Lexington Indoor Tennis Club**

Service No. **119**

Address **475 Bedford Street**

Location

~~REPAIRS~~—New Service Roland Patient Permit #153 W.O. #1298

MAR 14 1966

Date		Material	Amount	Total	Date	Amount
11-29-65		Labor	31.81		11-17-65	50 00
11-30-65		Labor	24.85	56 66	6-27-66	107 83
		10% O.H.	5 67	62 33		<u>157 83</u>
	9'	1 1/2" copper tubing @	1.55	13 95		
	1	6 x 1 1/2 nipple		86		
	1	3 x 1 1/2 nipple		65	9-7-84	208' 1 1/2" Copper
	1	1 1/2 x 12 saddle		13 14		
	1	1 1/2 Corp.		29 96		
	1	1 1/2 Curb		33 94		
	1	Hr. Town Truck		3 00		
				<u>157 83</u>		
		<u>OUTSIDE</u>				
	8'	1 1/2" copper tubing @	1.55	12 40		
12-16-65	545'	1 1/2" C.I. pipe				
						Bill sent 107.83

TOWN OF LEXINGTON — BOARD OF PUBLIC WORKS

WATER DIVISION

Sketch of Service Here

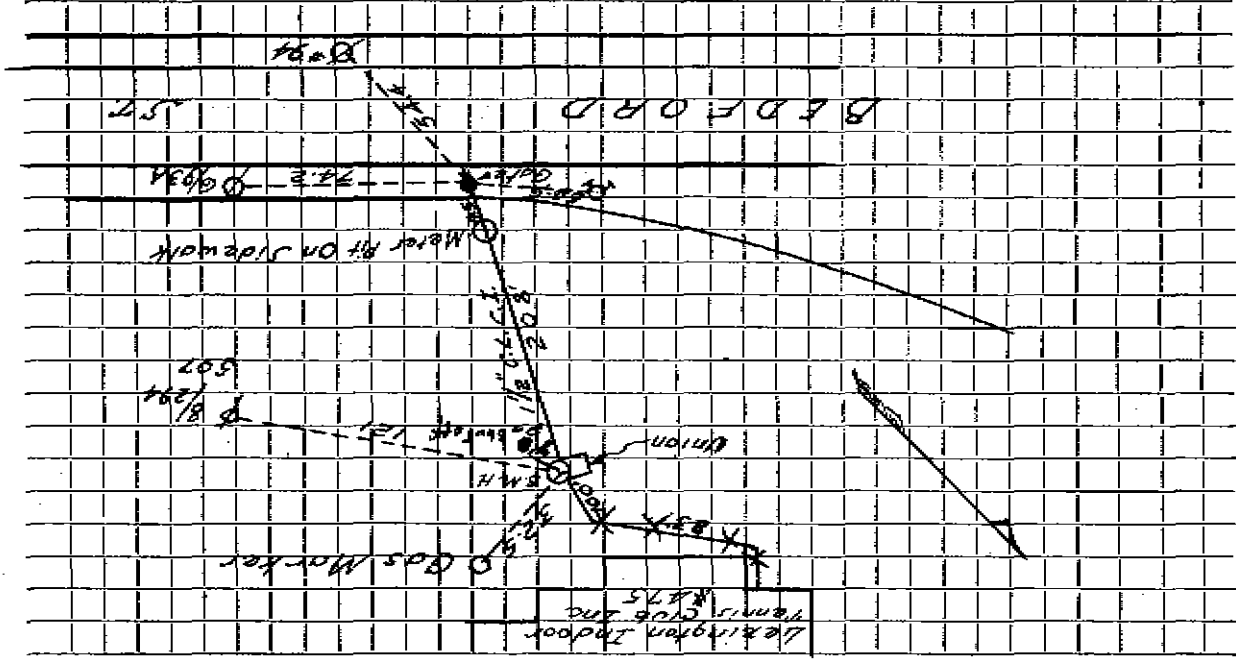

Connection made in

Street.

Work completed

Remarks: New copper 1/2" tied into C.P.