

TOWN OF LEXINGTON - BOARD OF PUBLIC WORKS  
WATER DIVISION

Date: 5/29/21

SKETCH OF SERVICE HERE

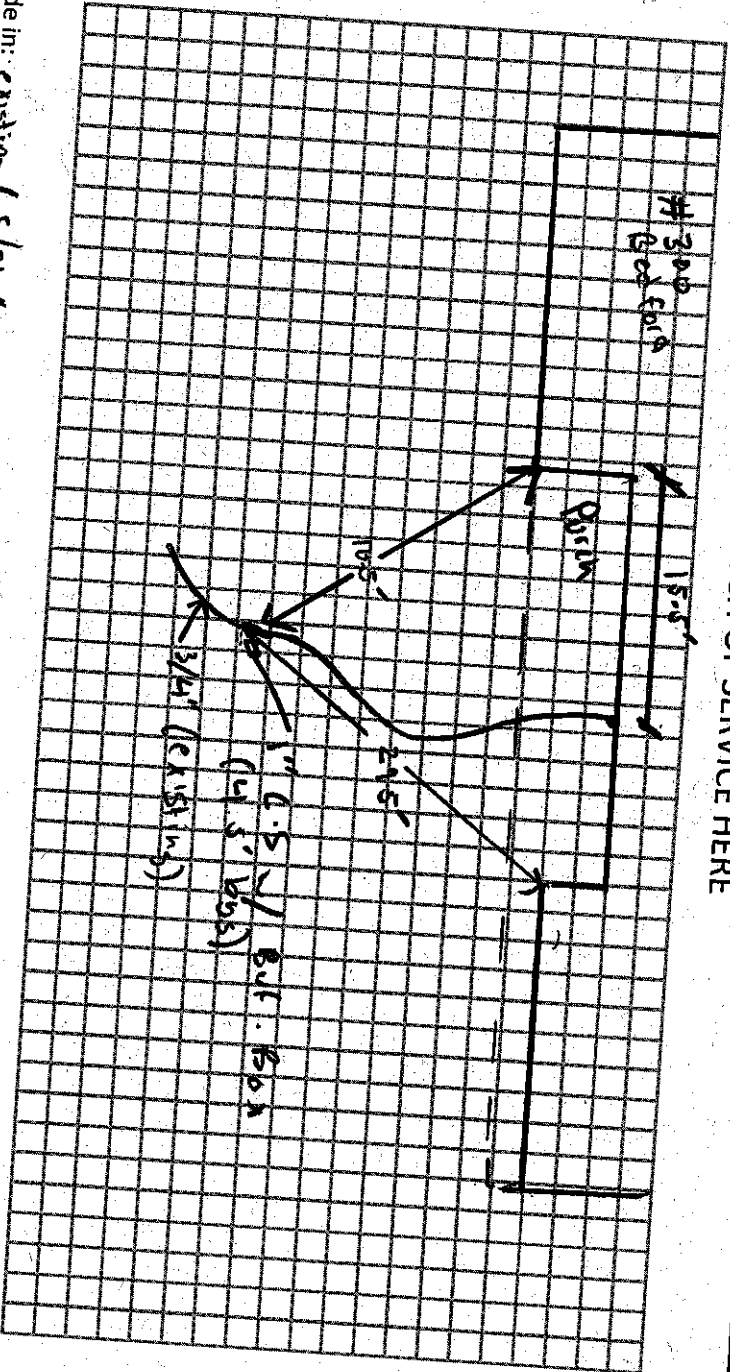

Connection made in: existing C.S./3/4" on site  
Remarks: (upgrade to 1") Street:

Work completed:

Address 300 Bedford St

Location

Repair - ~~Renewal~~ New Service

| Date | Material                        | Amount | Total | Date |  | A |
|------|---------------------------------|--------|-------|------|--|---|
| 3/27 |                                 |        |       |      |  |   |
|      | 3/4" → 1" Union                 | ①      |       |      |  |   |
|      | 1" Type K Pipe                  | ~ 1'   |       |      |  |   |
|      | 1" O. Right CS<br>(Buttala Box) | ①      |       |      |  |   |
|      | 1" Type K Copper                | ~ 25'  |       |      |  |   |
|      |                                 |        |       |      |  |   |
|      |                                 |        |       |      |  |   |
|      |                                 |        |       |      |  |   |
|      |                                 |        |       |      |  |   |
|      |                                 |        |       |      |  |   |
|      |                                 |        |       |      |  |   |
|      |                                 |        |       |      |  |   |
|      |                                 |        |       |      |  |   |
|      |                                 |        |       |      |  |   |
|      |                                 |        |       |      |  |   |

## WATER SERVICE RECORD

Name Richard Steele

Service No. 269

Address 300 Bedford Street

Location

~~Repair~~ ~~Renewal~~ New Service

Cmn 5-8-61

| Date     | Material                          | Amount | Total  | Date     | Amount                  |        |
|----------|-----------------------------------|--------|--------|----------|-------------------------|--------|
| 3-17-61  | Labor                             | 91.43  |        | 11-18-60 | Deposit                 | 150.00 |
|          | 10% O.H.                          | 9.14   | 100.57 | 4-8-61   | Paid by #111# 25.3      | 1.46   |
| 110      | 3/4" Copper tubing @.42           |        | 46.20  | 8-7-61   | Paid                    | 15.40  |
| 1        | 3/4" G x 1/2" T.L.H. Stop & Waste |        | 6.17   |          | NON CHARGE              | 167.26 |
| 2        | 3/4" G 3 part unions @2.41        |        | 4.82   | 3-17-61  | Labor                   | 8.32   |
| 1        | hr. Town Shovel @6.50             |        | 6.50   | 10'      | 3/4" Copper tubing @.42 | 4.20   |
| 1        | hr. Trucking @3.00                |        | 3.00   | 1        | 3/4" G Corp Cock        | 4.91   |
|          |                                   |        | 167.26 | 1        | 3/4" G Curb Cock        | 6.28   |
|          |                                   |        |        | 1        | Box & Rod               | 4.90   |
|          | REPAIR - NON-CHARGE W.O.#3455     |        |        | 1        | 1/2" Straight tailpiece | .50    |
| 10-13-66 | Labor                             | 41.80  |        | 1        | 1/2" Offset tailpiece   | .50    |
|          | 10% O.H.                          | 4.18   | 45.98  | 1        | hr. trucking @3.00      | 3.00   |
| 10'      | 3/4" copper tubing @ .79          |        | 7.90   |          |                         | 32.61  |
| 2        | 3/4" Unions @ 3.05                |        | 6.10   |          |                         |        |
| 2        | Hrs. Trucking @ 3.00              |        | 6.00   |          |                         |        |
| 1        | Hr. Tractor                       |        | 6.50   |          |                         |        |
|          |                                   |        | 72.48  |          |                         |        |

TOWN OF LEXINGTON — BOARD OF PUBLIC WORKS  
WATER DIVISION

Sketch of Service Here

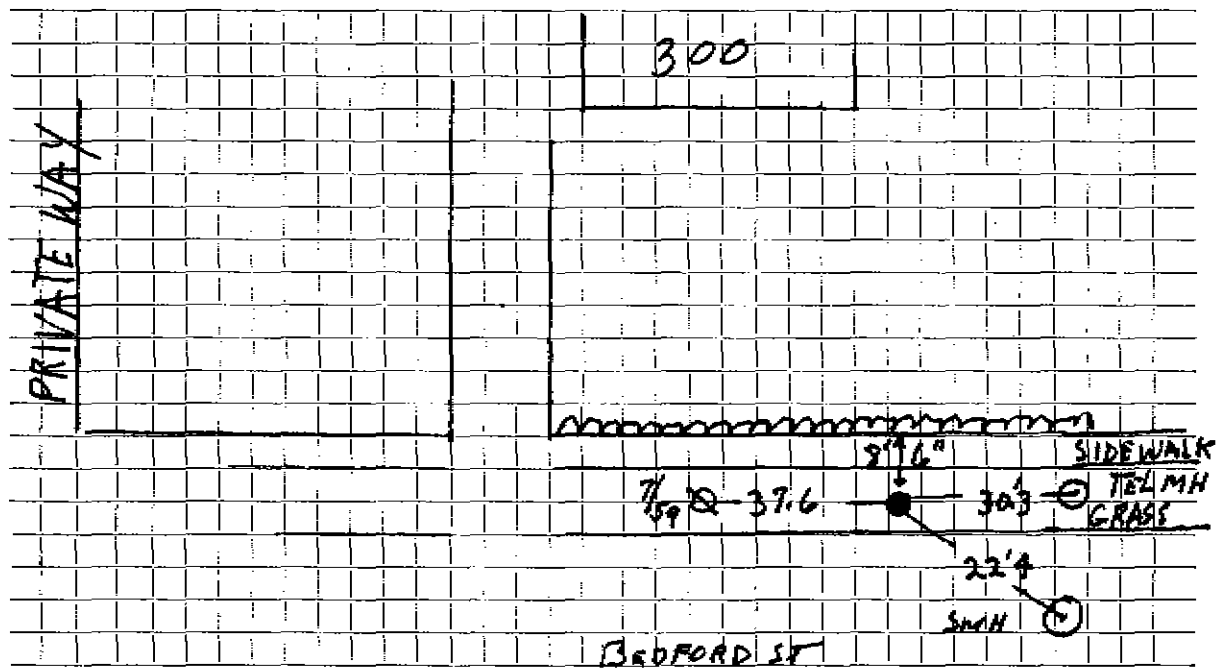

Connection made in ..... Street. Work completed .....

Remarks: .....  
.....  
.....