

WATER SERVICE RECORD

Name Kelly Corp.

Service No.

241

Address 8 Appletree Lane

Location Lexington

~~Repair~~ New Service

*Com. 12-1-52*

| Date     | Material                         | Amount | Total | Date                          | Amount                 |
|----------|----------------------------------|--------|-------|-------------------------------|------------------------|
| 10/28/52 | Labor                            | 1 63   |       | 10-9-52                       | Deposited 10 -         |
|          | 10% overhead                     | 16     | 1 79  | 12-1-52                       | Refunded 72            |
|          | 3' -3/4" copper tubing@.34       |        | 1 02  |                               | <u>NON CHARGE</u> 9 28 |
|          | 1 -3/4" Cx 1/2 I.W.H.stop& waste |        | 4 00  | 10/28/52                      | Labor 3 93             |
|          | 1 -3/4"C x 3/4"C.union           |        | 1 72  | 9' - 3/4" copper tubing@.34   | 3 06                   |
|          | 1 hr. trucking                   |        | 75    | 1 - 3/4" C. corp-cock         | 4 33                   |
|          |                                  |        | 9 28  | 1 - 3/4" C x 3/4" C.curb-cock | 4 67                   |
|          | TRENCH DUG BY OWNER              |        |       | 1 box and rod                 | 3 90                   |
|          | PIPE SUPPLIED AND LAID BY OWNER: |        |       | 1 - 1/2 offset tail piece     | 50                     |
|          |                                  |        |       | 1 - 1/2 straight tail piece   | 50                     |
|          |                                  |        |       | 1 hr. trucking                | 75                     |
|          |                                  |        |       |                               | <u>21 64</u>           |

DATE \_\_\_\_\_

TOWN OF LEXINGTON — BOARD OF PUBLIC WORKS

**WATER DIVISION**

Sketch of Service Here

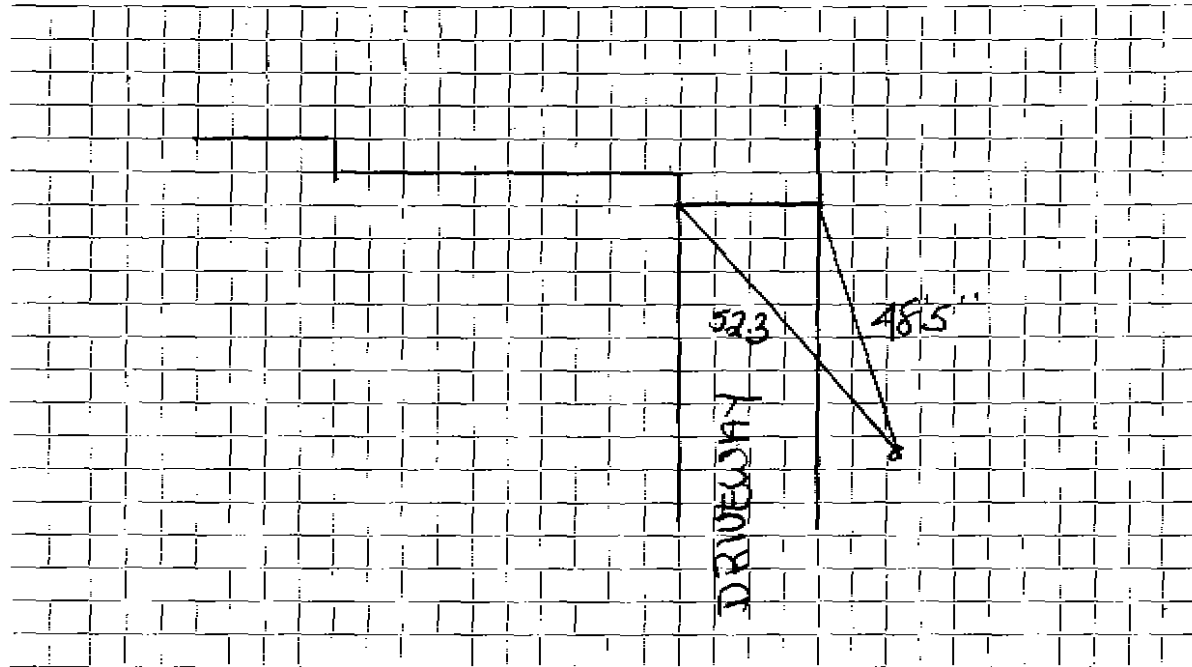

Connection made in ..... Street. Work completed .....

Remarks: .....

.....

.....