

Name **Emma Nash**Service No. **16 980**Address **12 Theresa Avenue**

Lexington, Mass.

Location **12 Theresa Avenue**

Kind of Pipe

Size **6"**Size of Main **8"**

Repair—Renewal—New Service

Location

Date	Material	Amount	Total	Date	Amount
10-16-45	Labor	34 87		Oct 10, 45	100 00
10-17-45	"	24 84	59 71	Nov. 15, 45	20 44
	10% Overhead		5 97		79 56
	32' - 6" Sewer Pipe @.22		7 04		
	10' - 4" Iron Pipe @.26		2 60		
	1 - 6" Elbow		70		
	Joint Compound		2 04		
	Trucking 2 hrs. @.75		1 50		
			79 56		
	Labor				

TOWN OF LEXINGTON—DEPT. OF PUBLIC WORKS

SEWER DIVISION

DATE

NO.

The undersigned applies for the construction of a particular sewer connecting No. Street and hereby agrees to comply with the Rules and Regulations governing the construction and use of Particular Sewers, as now or at any future time established by the Board of Selectmen.

Am't of estimate \$.....

Am't Paid \$.....

..... Owner

Sketch of Service Here **12**

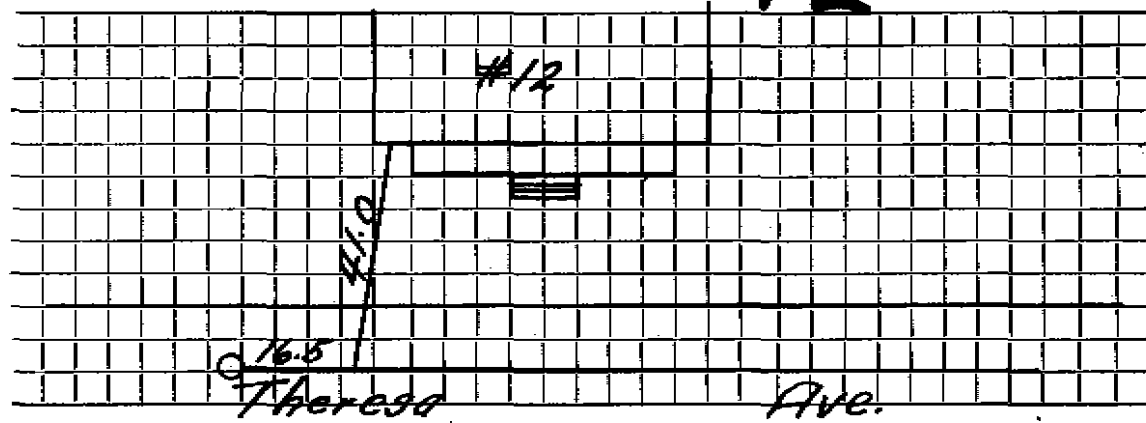

Connection made in Street.

Work completed 19..

Remarks: