

Name **Waverley Construction Company**

Service No. **1066**

Address **31 Taft Avenue**

Lexington, Mass.

Location **31 Taft Avenue**

Kind of Pipe

Size **6"**

Size of Main **8"**

Repair ~~Renewal~~ **New Service**

Location

Date	Material	Amount	Total	Date	Amount
Mar. 12, '47	Labor	39 53		Mar 11 47	Deposited 25 00
Mar. 13, '47	"	<u>10 80</u>	50 33	May 22 47	paid 1 21
	10% Overhead		5 03		
	58' - 6" Sewer Pipe @.24		13 92		
	1 @ 6" Elbow		1 28	Bill sent 5-14-47	
	Joint Compound		3 48		
	Compressor 1 hr. @ 1.75		1 75		bal. due 58¢
	Trucking 2 hrs. @.75		<u>1 50</u>		
			77 29		
	Labor				

TOWN OF LEXINGTON—DEPT. OF PUBLIC WORKS
SEWER DIVISION

DATE

NO.

The undersigned applies for the construction of a particular sewer connecting No. Street and hereby agrees to comply with the Rules and Regulations governing the construction and use of Particular Sewers, as now or at any future time established by the Board of Selectmen.

Am't of estimate \$.

Am't Paid \$.

..... Owner

Sketch of Service Here **31**

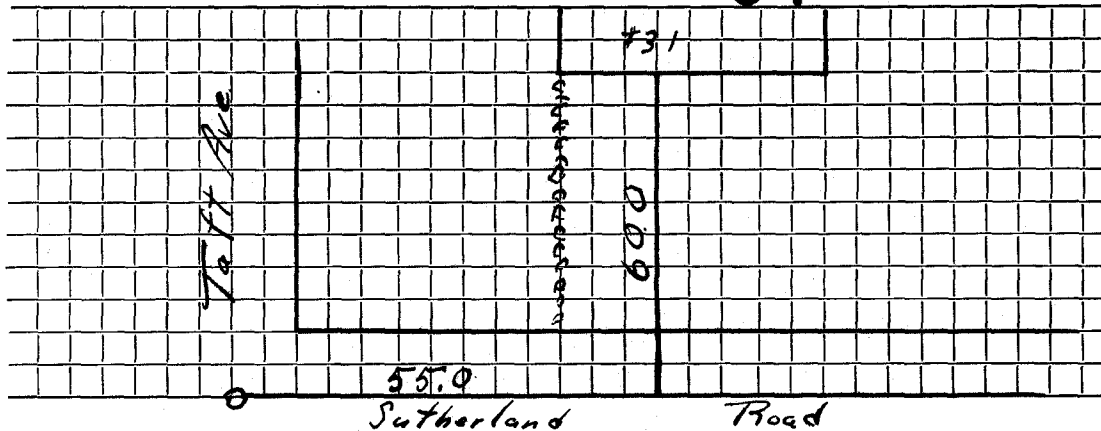

Connection made in Street. Work completed 19..

Remarks: