

Name William C. O'Leary

Service No. II 903

Address 30 Shirley Street, Lexington

30 Shirley Street Location Same

Kind of Pipe

Size 6"

Size of Main 8"

~~Repair - Renewal~~ - New Service

Location

Date	Material	Amount	Total	Date	Amount
1935					
June 22	26 hrs. @ 55¢	14 30		June 21 1935	Cash 81 00
<sup>700 Com. to</sup> Russell 7/16/35	15 " @ 60¢	9 00		Nov 1 1935	" 69
<sup>69 Com. to</sup> Russell 11-12-35	10% Overhead on labor	2 33	25 63		81 69
	33' 6" Sewer pipe @20¢		6 60		
	Sulphur & Jute		75		
	Compressor 1 hr.		2 50		
	Trucking 2 hrs. @\$1.50		3 00		
			38 48		
	Other house		43 21		
			81 69		
	Say \$81.00				
	Labor				

TOWN OF LEXINGTON—BOARD OF PUBLIC WORKS

SEWER DIVISION

DATE 6-14-35

NO. \_\_\_\_\_

The undersigned applies for the construction of a particular sewer connecting No. 30 Shuley St. Street and hereby agrees to comply with the Rules and Regulations governing the construction and use of Particular Sewers, as now or at any future time established by the Board of Selectmen.

Am't. of Estimate \$ ~~812~~ 112.00

Am't. Paid \$ ~~812~~ 31.00

William O'Leary Owner

Sketch of Service Here

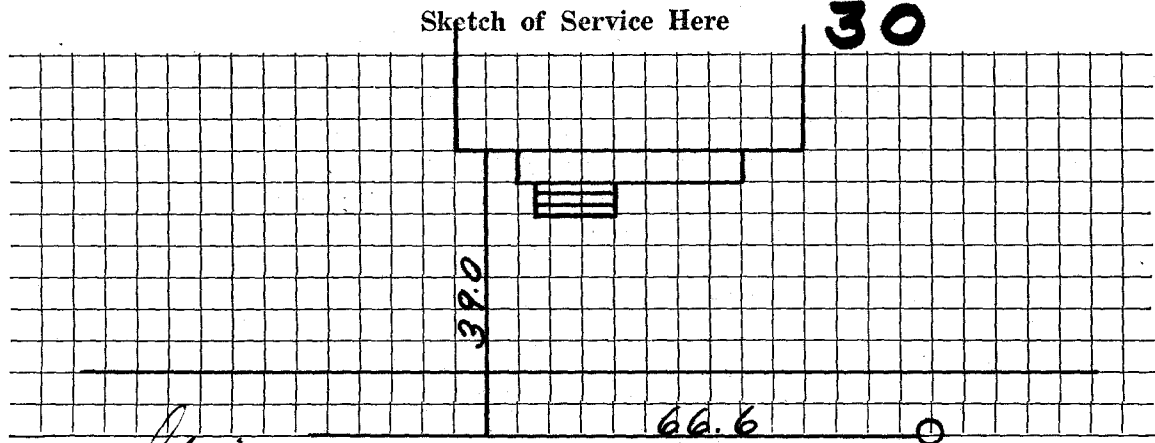

Connection made in Shuley Street.

Work completed \_\_\_\_\_ 19

Remarks: Owner to dig own trench to street line