

Name John Ritchie

Service No. 88

Address 37 Sherburne Road

37 Sherburne Road

Location

Kind of Pipe

Size 6"

Size of Main 8"

~~REPAIR/RENEWAL~~ New Service W.O. #590 David Eagle Permit #375

Location MAR 14 1966

Date	Material	Amount	Total	Date	Amount	
7/2/65	Labor	60 40		7-1-65	Deposit	125 00
	10% O.H.	6 04	66 44	3-4-66	Retained	18 08
	11' 6" Transite pipe @.82		9 02			106 92
	1 22 1/2 Bend		4 09	12-1 86		
	1 11 1/2 Elbow		2 35		1 6" PVC-AC FERNCO	
	1 6" Cap		1 93		12'5" 6" PVC PIPE	
	20 Brick @ 4.20 per 100		84		1 6" AC-PVC ADAPTOR	
	1/2 Bag Cement @ 1.50		75			
	10 x 3 Patch		10 00	1-10-89	4.6 6" PVC Pipe	
	1 Hr. Town Truck		3 00		1 6" PVC-PVC Adaptor	
	1 Hr. Town Shovel		6 50	7-31-89	Repair Gas Buck of Card	
	1/2 Hr. Loader @ 4.00		2 00			
			106 92	12-1-86	REPAIRED BY TOWN	
					we Rod out until repaired	
				11-20-86	Roots 47'	
7-8-65	31 6" Transite pipe				7-19-74 Roots out	48' out
				3-22-77 -	PAPERS 47-50'	
				1-9-69		

DATE _____

TOWN OF LEXINGTON — BOARD OF PUBLIC WORKS

SEWER DIVISION

37 Sketch of Service Here

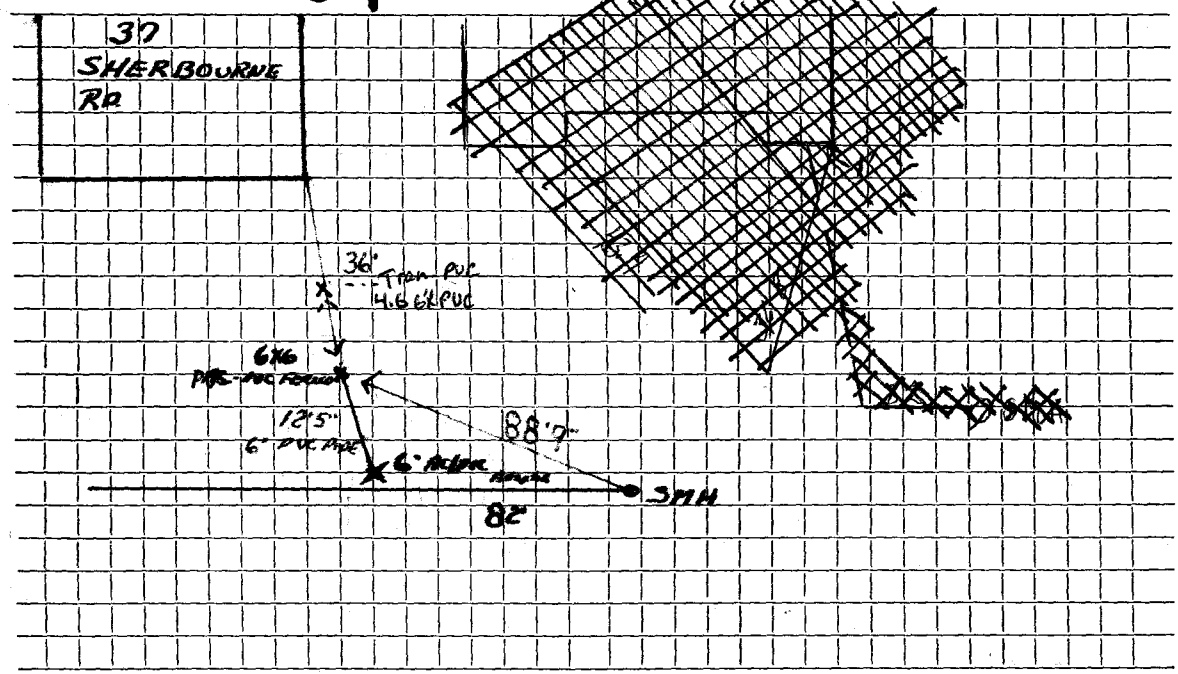

REPAIR
 12-1-86
 1-10-89

Connection made in Street. Work completed

Remarks: .. Sewer .. 7 1/2' Deep from ground level ..
 .. We Inspected .. Pipe .. 1-10-89 .. Found paper & Grease @ Lip in Pipe @ main ..
 .. 7-31-90 .. Repair .. 3' 6" PVC .. 1.8 x 8 x 6 P.V.C. Tee .. 1 1/2" PVC ..
 .. 2 8" CI-PVC Ferroc 1 1/2" 1 1/2" Collar Band