

Name Annie M. St.George

Service No. 191

Address 76 Reed Street

76 Reed Street

Location

Kind of Pipe

Size 6"

Size of Main 8"

~~XXXXXX~~ New Service

Location Comm 3-16-59

Date	Material	Amount	Total	Date	Amount
2-2-58	Labor	7.69		10-31-58	180 00
2-3-58	Labor	58.95	66 64	11-16-58	21 16
	10% O.H.	6.66	<del>66 64</del>		158 84
	60' 6" Transite pipe @.70		42.00		
	1 6" Transite Elbow 90°		5.29		
	11 x 3 Patch		11.00		
	1 hr. Pippin @4.50		4.50		
	2 hrs. Town Shovel @ 6.50		13.00		
	1 hr. Trucking @.75		.75		
	1 hr. Trucking @3.00		3.00		
	1 hr. Rodgers Trailer @3.00		3.00		
	1 hr. Hough Loader @ 3.00		3.00		
	<b>Labor</b>		<b>158.84</b>		

Free This Service  
measure and Advise

DS  
9/12/83

# TOWN OF LEXINGTON—DEPT. OF PUBLIC WORKS

## SEWER DIVISION

DATE.....

NO. ....

The undersigned applies for the construction of a particular sewer connecting No.....  
 Street and hereby agrees to comply with the Rules and Regulations governing the construction and use of Particular  
 Sewers, as now or at any future time established by the Board of Selectmen.

Am't of estimate \$.....

Am't Paid \$.....

..... Owner

Sketch of Service Here **76**

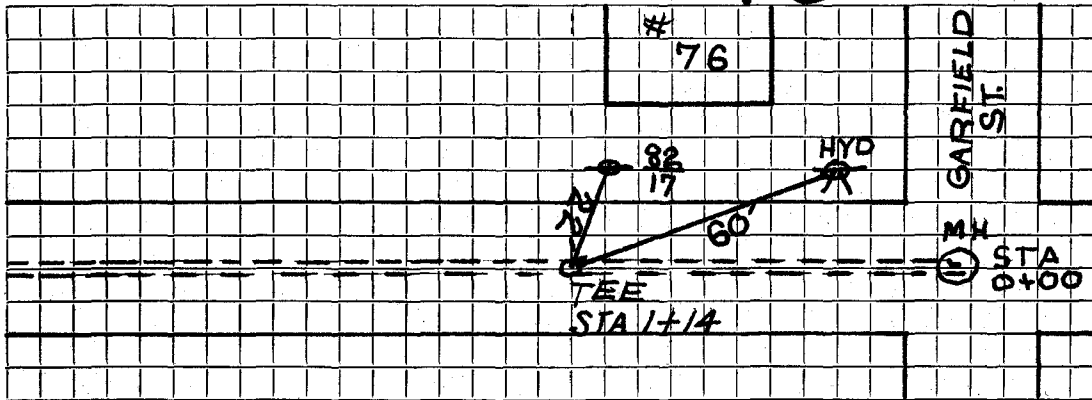

Connection made in..... Street.

Work completed.....19..

Remarks: