

Name Pelham Const. Inc.

Service No.

Address 25 Phinney Road

25 Phinney Road

Location

Kind of Pipe

Size 6"

Size of Main 8"

Repair—Renewal—New Service DeFlice #1291

Location

Date		Material	Amount	Total	Date	Amount
4-17-69	30'	6" Transite pipe				
	15'	4" Cast Iron pipe				

DATE _____

TOWN OF LEXINGTON — BOARD OF PUBLIC WORKS

SEWER DIVISION

Sketch of Service Here

25

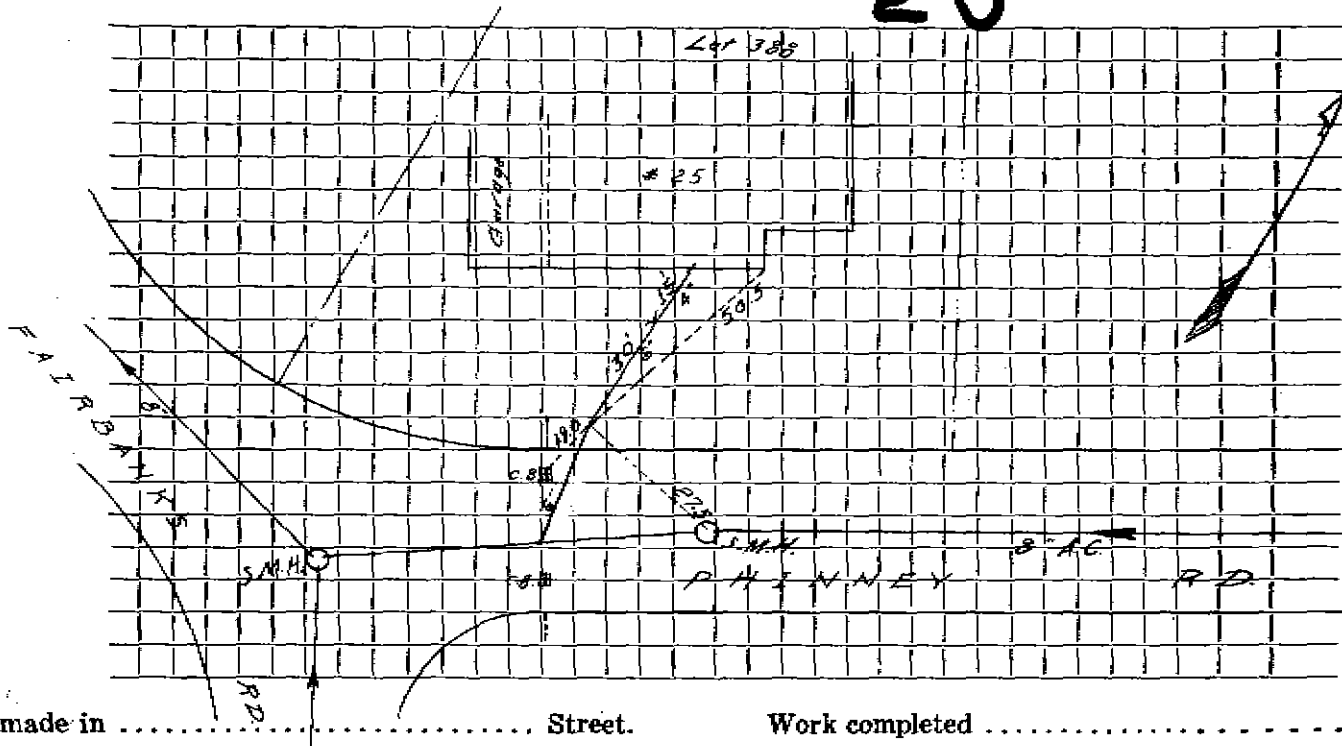

Connection made in Street. Work completed

Remarks:

.....

.....