

Name

Service No.

Address 9 Pelham Rd

Location

Kind of Pipe SDR 35 PVC

Size 6"

Size of Main

Repair—Renewal—New Service tied into existing PVC stubs installed during Pelham Sewer Main Proj

Date	Material	Amount	Total	Date	Amount
------	----------	--------	-------	------	--------

11/21/1	6" PVC cleanout				
---------	-----------------	--	--	--	--

	6" PVC SDR 35				
--	---------------	--	--	--	--

	PVC to PVC stub				
--	-----------------	--	--	--	--

TOWN OF LEXINGTON — BOARD OF PUBLIC WORKS  
SEWER DIVISION

Sketch of Service Here

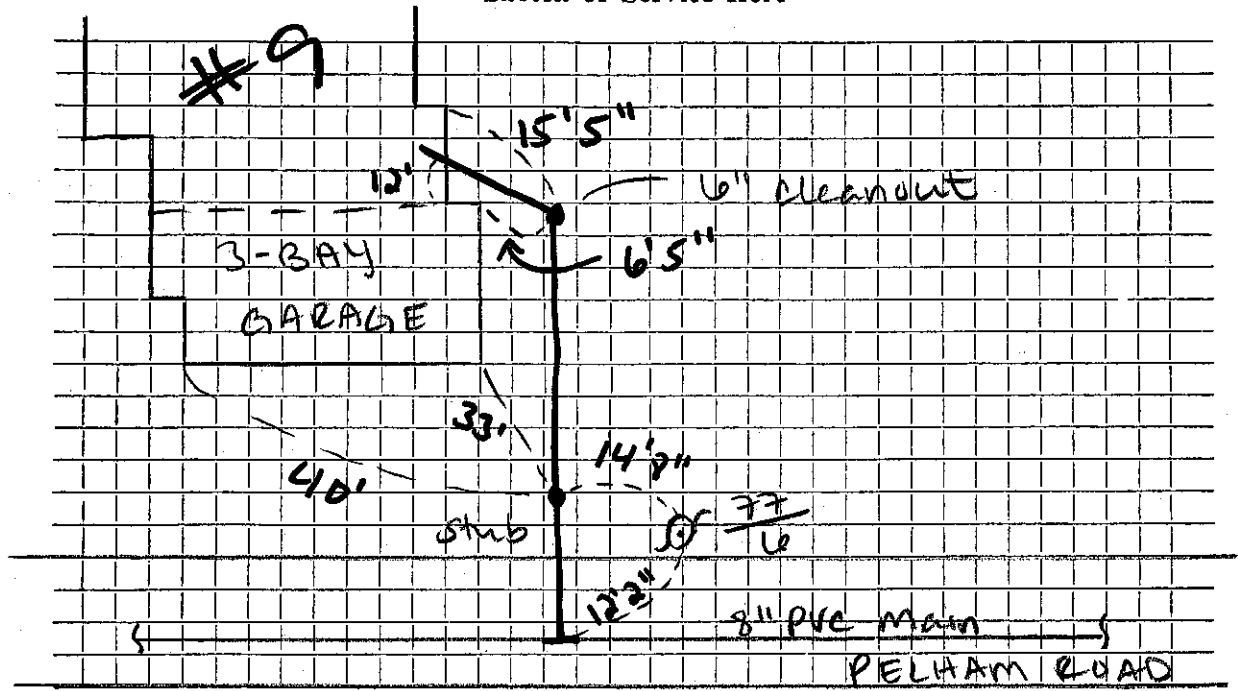

Connection made in Pelham Rd Street. Work completed .....

Remarks: Main to stub = 16', stub to cleanout = 75', cleanout to foundation = 13'  
.. depth @ stub = 10'6"

.. New sewer main & stub installed during Pelham Rd Sewer Main Replacement  
2020