

Name **Robert L. Rosenthal**Service No. **#51**Address **10 Peacock Farm Road****10 Peacock Farm Rd.**

Location

Kind of Pipe

Size **6"**Size of Main **8"**~~REPAIRS~~ — **New Service**Location **Comm 6-25-62**

Date	Material	Amount	Total	Date	Amount
-21-62	Labor	96.50		5-11-62	300.00
-22-62	"	17.24	113.74	6-25-62	46.71
	10% O.H.	11.37	125.11		253.29
61'	6" Transite Pipe @78		47.58		
2	11 1/4" Transite Bend @5.10		10.20		
2	22 1/2" Transite Elbows @2.24		4.48		
2	90" Transite Elbows @5.40		10.80		
1	Duplex Adapter		1.62		
3	X 12 Patch		12.00		
5	Hrs. Town Shovel @6.50		32.50		
3	Hrs. Trucking @3.00		9.00		
			<u>253.29</u>		

TOWN OF LEXINGTON — BOARD OF PUBLIC WORKS

SEWER DIVISION

Sketch of Service Here

10

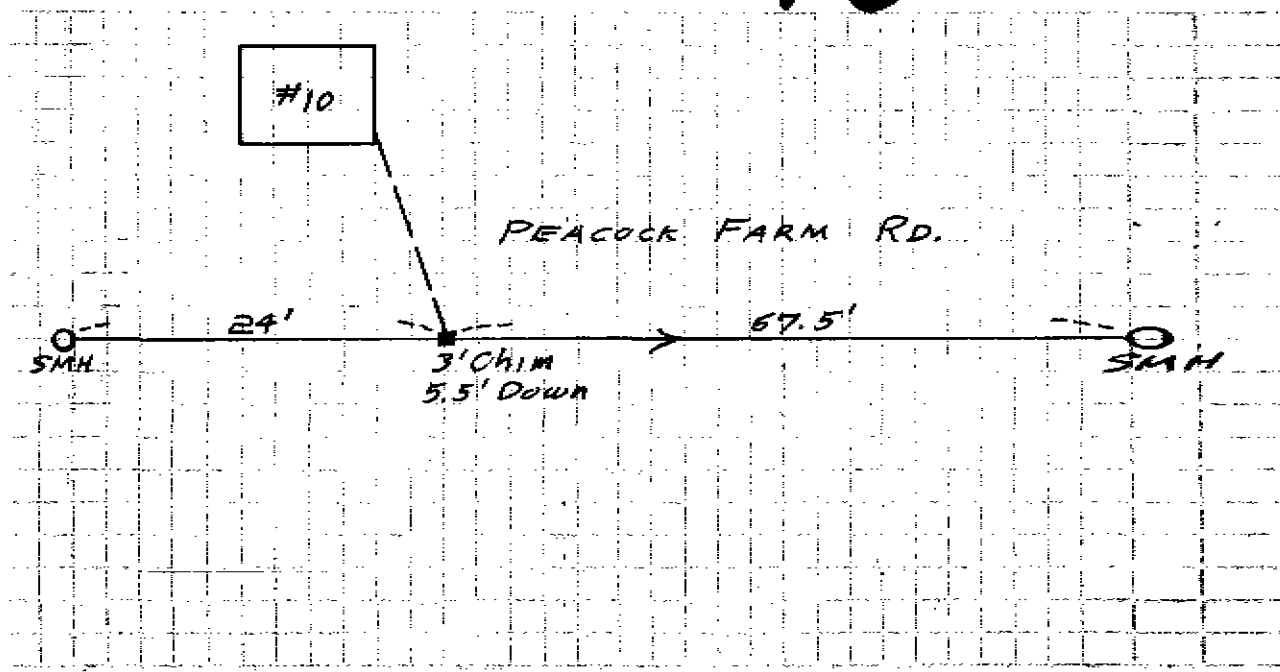

Connection made in Street. Work completed

Remarks: