

Name

Service No.

Address

814 Mass Ave

Location

Kind of Pipe

SDR Sch. 35 PVC

Size

6"

Size of Main

Repair

~~Renewal~~

New Service

Location

Date

Material

Amount

Total

Date

Amount

9/21/21

SMH w/ concrete  
traph

ferro to  
existing 6" clay  
(lined)

6" cleanout w/  
tee wye

2-11° Bend

DATE 9/21/21

TOWN OF LEXINGTON — BOARD OF PUBLIC WORKS  
SEWER DIVISION

Sketch of Service Here

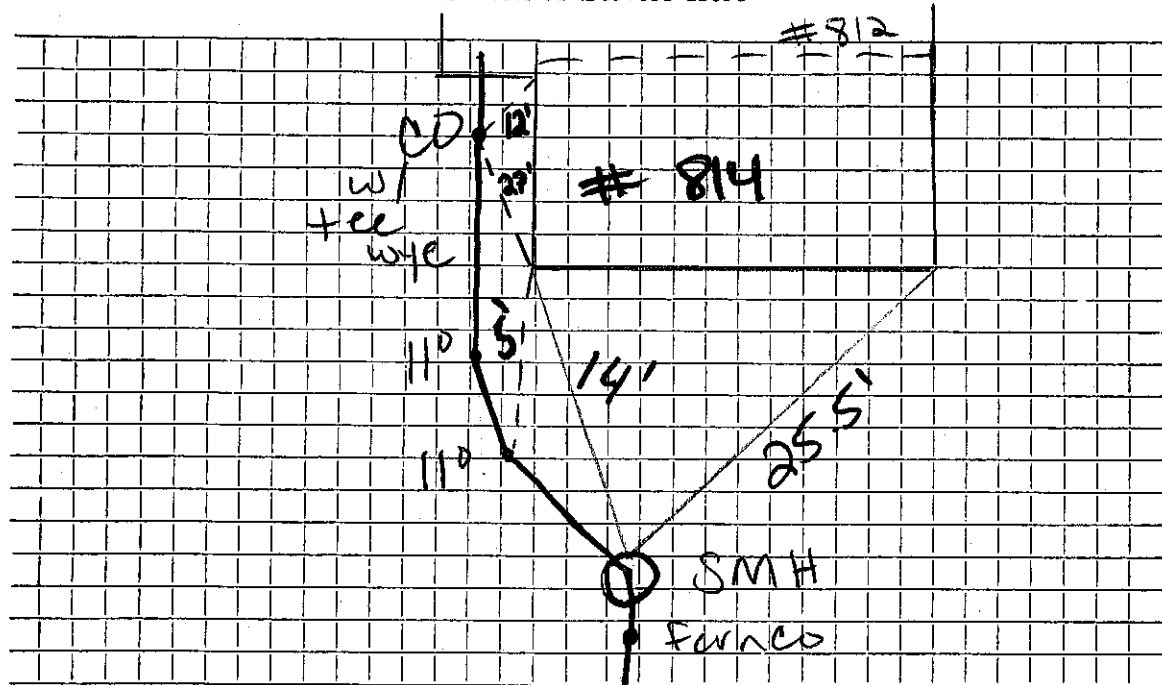

Connection made in Mass Ave Street. Work completed existing 6" clay (lined)

Remarks: SMH also has # 812 sewer service connected.