

Name Development Corp.

Service No. 116

Address 2300 Massachusetts Ave.

2300 Mass. Ave.

Location

Comm. 11-18-57

Kind of Pipe

Size

Size of Main

~~Repair~~ ~~Renewal~~ — New Service

Location

Date	Material	Amount	Total	Date	Amount
8/29/57	Labor	61 95		8-13-57	Deposit \$ 200 00
		33 69		11-18-57	Paid by refund 6 50
		95 64			on W. H. C. # 177 \$ 206 50
	10% overhead	9 56			
			105 20	8/21/96	REPAIR
	72' 6" transite pipe @ .70		50 40	4'	6" PVC
	20' 6" clay pipe @ .435		8 70	2	AC. TO PVC FERRO
	Joint compound		1 20		
	20 x 3 patch		20 00		
	3 hrs. town shovel @ 6.50		19 50		
	2 hrs. trucking @ .75		1 50		
			206 50		
	Labor				

**TOWN OF LEXINGTON—DEPT. OF PUBLIC WORKS
SEWER DIVISION**

DATE.....

NO.

The undersigned applies for the construction of a particular sewer connecting No.....
Street and hereby agrees to comply with the Rules and Regulations governing the construction and use of Particular
Sewers, as now or at any future time established by the Board of Selectmen.

Am't of estimate \$.....

Am't Paid \$.....

..... Owner

Sketch of Service Here **2300**

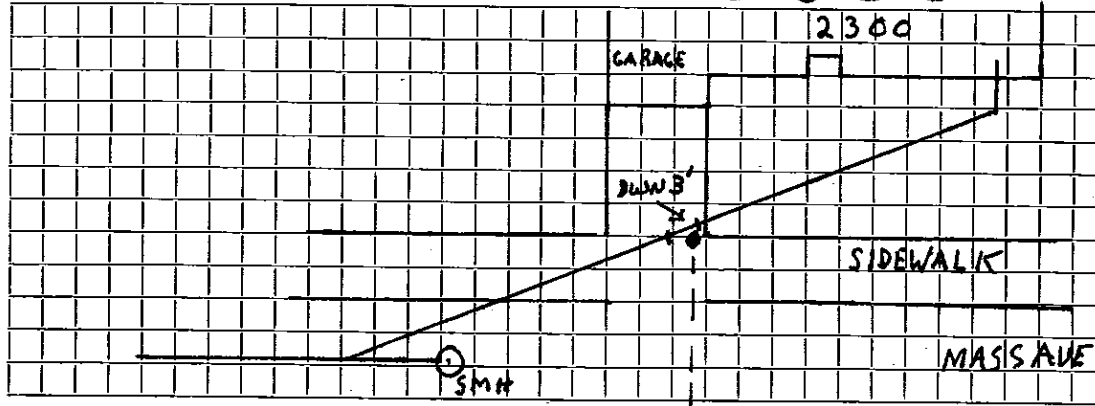

Connection made in MASS AVE Street.

12th MAIN
Work completed.....19..

Remarks: 8/21/96 REPAIR AT CURB BOX