

Name Robert B. Wardwell

Service No. 128

Address 41 Grant St.

Location

Kind of Pipe

Size

Size of Main

~~Repair~~ Renewal—New Service W±0± # 7052

Location DEC 22 1969

| Date     | Material             | Amount | Total  | Date                 | Amount         |
|----------|----------------------|--------|--------|----------------------|----------------|
| 10/28/69 | Labor                | 186 03 |        | 10-30-69             | 450 00         |
| 11/12/69 | "                    | 9 43   | 195 46 | 12-22-69             | 153 86         |
|          | 10& O.H.             |        | 19 55  |                      | ---            |
| 34'      | 6" Transite pipe .88 |        | 29 92  | 11/12/69             | Patching 30 00 |
| 10"      | 4" Cast Iron 1.65    |        | 16 50  |                      |                |
| 1/2      | Bag cement 1.55      |        | 78     |                      |                |
| 1/2      | Ton cold Patch 5.85  |        | 2 93   |                      |                |
| 2        | Hrs. trucking 3.00   |        | 6 00   |                      |                |
| 2        | " " 1.50             |        | 3 00   |                      |                |
| 2        | " Shovel 6.50        |        | 13 00  | 2/16/83              |                |
| 1        | " Loader             |        | 4 00   | TOWN WILL RESPOND    |                |
| 1        | " Compressor         |        | 5 00   | TO BLOCKED SEWER     |                |
|          |                      |        | 296.14 | SERVICE TO DETERMINE |                |
|          |                      |        |        | WHERE THE PROBLEM IS |                |
|          |                      |        |        | LOCATED J M Y        |                |

DATE \_\_\_\_\_

TOWN OF LEXINGTON — BOARD OF PUBLIC WORKS

SEWER DIVISION

Sketch of Service Here **41**

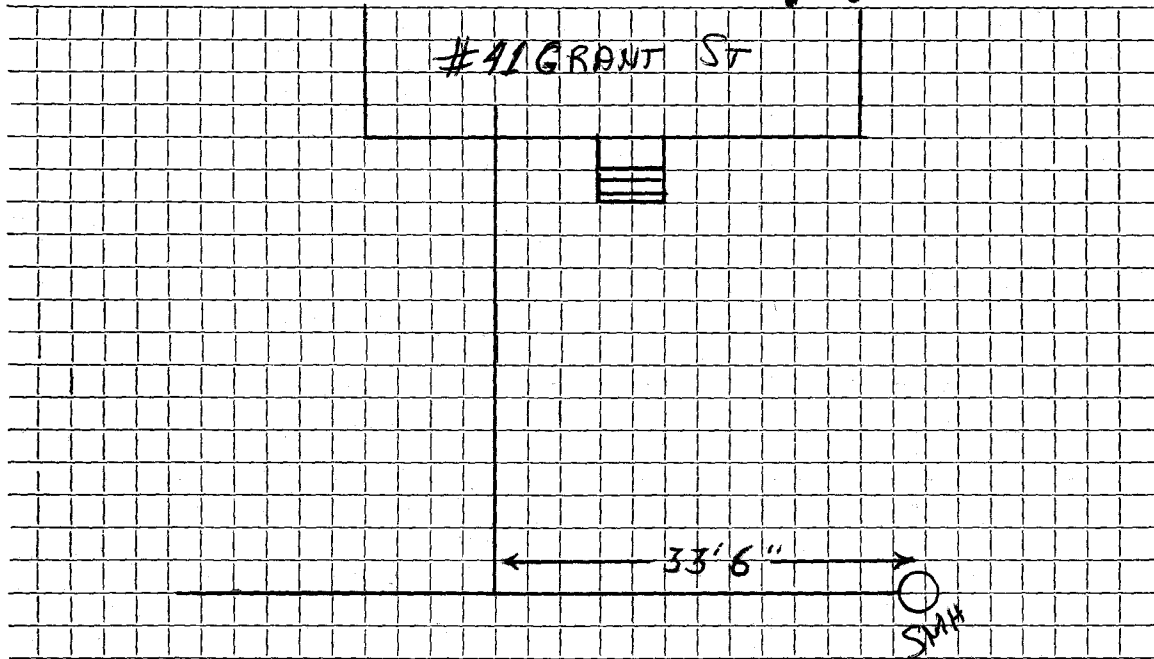

Connection made in ..... Street. Work completed .....

Remarks: .....  
.....  
.....