

Name Mrs George A. Talland

Service No. 31

Address 24 Forest Street

Location

Kind of Pipe

Size

Size of Main

Repair—Renewal—New Service W.O. #6684

Location NOV 18 1968

Date	Material	Amount	Total	Date	Amount
6-5-68	Labor 48.36			8-16-68	12.50
6-6-68	" 9.54	57.90		12-10-68	12.79
	10% O.H.	5.79	63.69		187.79
25'	4" Cast iron pipe @1.65		22.00		OUTSIDE
1/2	yd. loam @3.50		1.75	6-5-68	Labor 21.48
1	lb. Grass Seed		1.10	6-6-68	" 19.08
3	hrs. Trucking @3.00		9.00		Soil pipe to sewer
1	hr. Town Shovel		6.50	17'	4" Cast iron pipe
1	hr. Roller		3.00	10	Bricks
1	hr. Trailer		2.00	1	Bag Cement
	Soil Pipe to Sewer		78.75	3	ton Hot Top @5.75
			187.79	5	hrs. Truck
				1	hr. Shovel
				1	hr. Loader
				1	hr. Compressor
				1	hr. Roller & Trailer
					5.00
					167.57

DATE _____

TOWN OF LEXINGTON — BOARD OF PUBLIC WORKS

SEWER DIVISION

Sketch of Service Here **24**

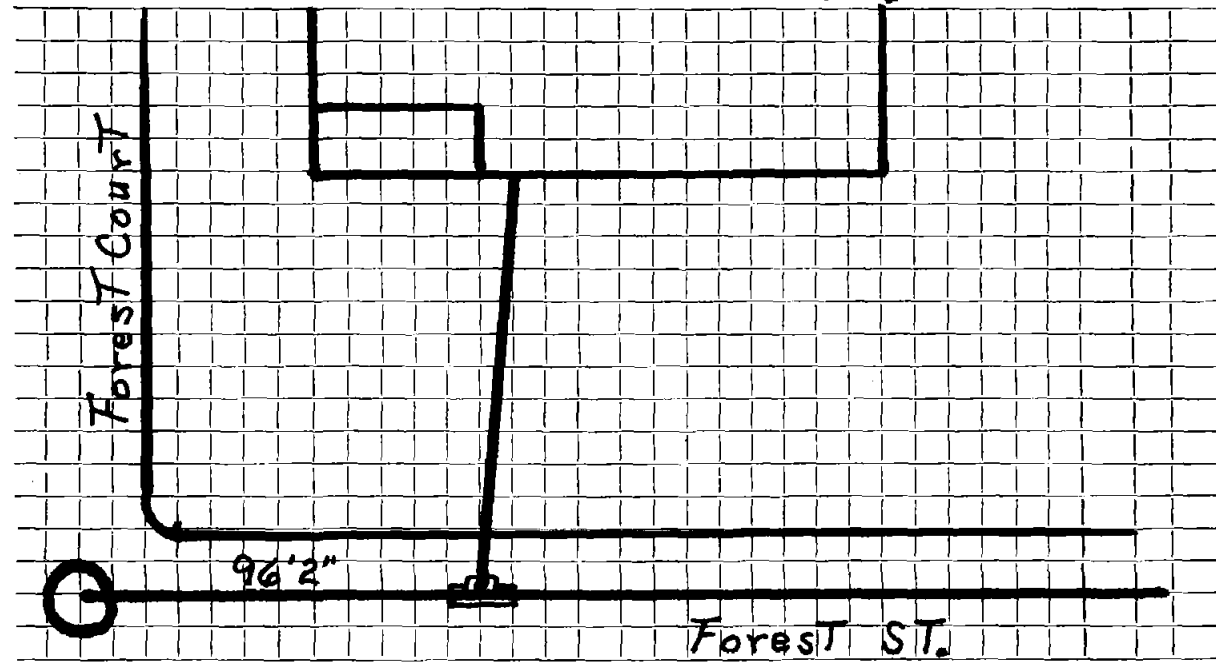

Connection made in Street. Work completed

Remarks:
.....
.....