

TOWN OF LEXINGTON — BOARD OF PUBLIC WORKS

SEWER DIVISION

DATE 4/21/21

Sketch of Service Here

- Legend:
- A = 22° Bend
  - B = 22° Bend
  - C = 4" x 6" Ferried
  - D = Cleanout

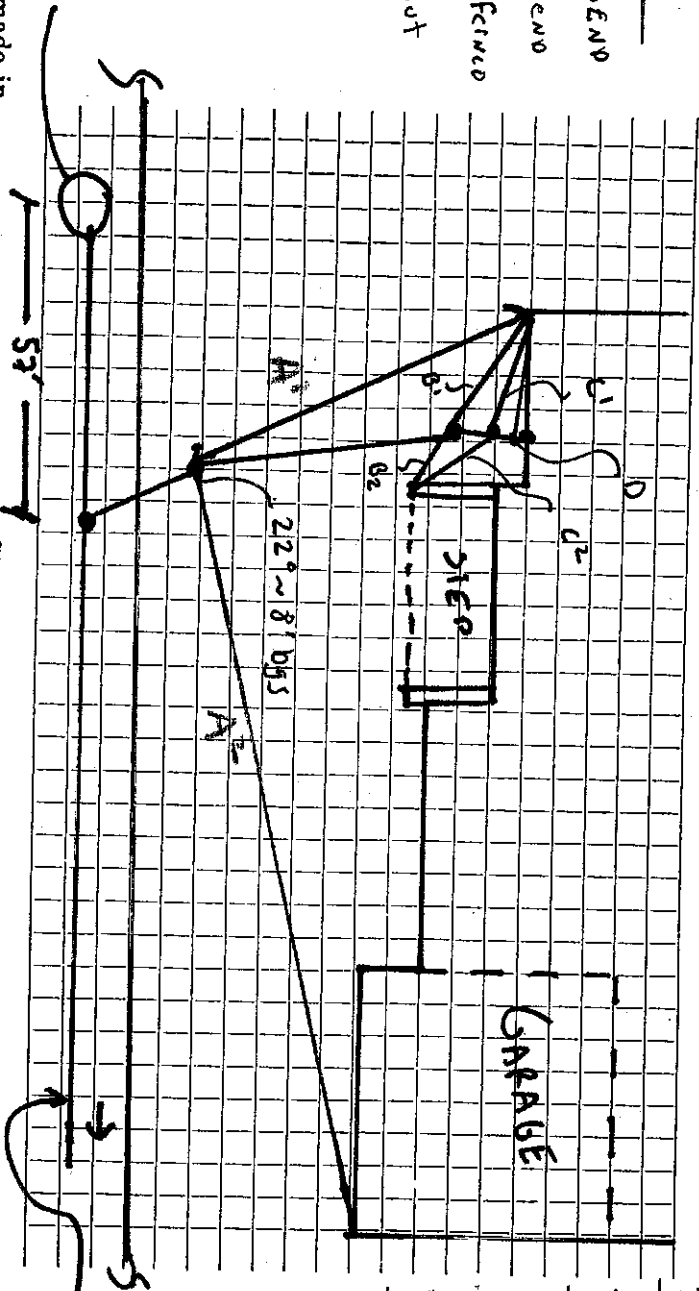

TIE DIMENSIONS

A <sup>1</sup>	5.6 ft
A <sup>2</sup>	53.5 ft
B <sup>1</sup>	18.5 ft
B <sup>2</sup>	3.25 ft
C <sup>1</sup>	13.5 ft
C <sup>2</sup>	4.5 ft
D <sup>1</sup>	12.5 ft

SEWER M.H. Connection made in Street. Work completed

Existing Town 8" L. LINE

Remarks: .....

Name **McLaughlin, JAMES M. INC.**

Service No. **WW-21-21**

Address **19 FAIRBANKS**

Location

Kind of Pipe **PVC SDR-35**

Size **6"**

Size of Main **7"**

Repair ~~Renewal~~ **New Service**

Location

Date	Material	Amount	Total	Date	Amount
4/21/21	ROAD → House			6" SDR-35	10'8"
	Existing AL 8x6" <sup>①</sup> Zec			4" x 6" FerriCo	①
	6" x 6" FerriCo <sup>①</sup>			4" PVC To Clean OUT	6'10"
	6" SDR-35	14ft		4" PVC TO FWD	1'6"
	22° BEND <sup>①</sup>				
	6" SDR-35	42ft			
	22° bend <sup>①</sup>				



DATE \_\_\_\_\_

TOWN OF LEXINGTON — BOARD OF PUBLIC WORKS

SEWER DIVISION

Sketch of Service Here

19

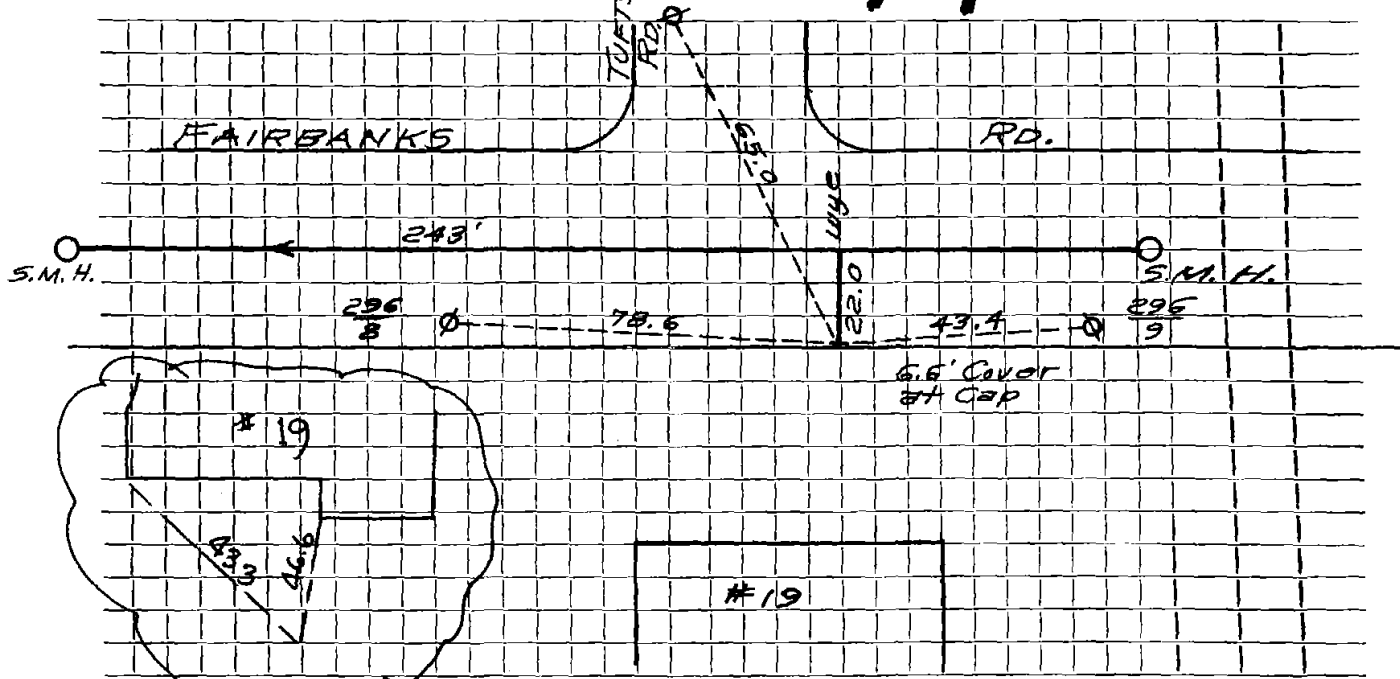

Connection made in ..... Street. Work completed .....

Remarks: .....  
.....  
.....