

Name **Mason McPhee**Service No. **1090**Address **62 Dexter Road**

Lexington, Mass.

Location **62 Dexter Road**

Kind of Pipe

Size

Size of Main

~~Repair~~ ~~Renewal~~ **New Service**

Location

| Date | Material | Amount | Total | Date | Amount |
|---------------|---------------------------|--------|--------|--------------|--------|
| Sept. 25, '47 | Labor | 34 23 | | Sept. 23 '47 | 120 00 |
| Oct. 20 '47 | " | 14 25 | | Nov. 29 '47 | 10 95 |
| " 21 | " | 15 50 | 63 98 | | 109 05 |
| | 10% Overhead | | 6 40 | | |
| | 56' - 6" Sewer Pipe @ .26 | | 14 56 | | |
| | Joint Compound | | 3 36 | | |
| | Trucking 1 hr. @ .75 | | 75 | | |
| | Patching 20 x 3 | | 20 00 | | |
| | | | 109 05 | | |
| | Labor | | | | |

TOWN OF LEXINGTON—DEPT. OF PUBLIC WORKS
SEWER DIVISION

DATE

NO.

The undersigned applies for the construction of a particular sewer connecting No.
Street and hereby agrees to comply with the Rules and Regulations governing the construction and use of Particular
Sewers, as now or at any future time established by the Board of Selectmen.

Am't of estimate \$.....

Am't Paid \$.....

..... Owner

Sketch of Service Here **62**

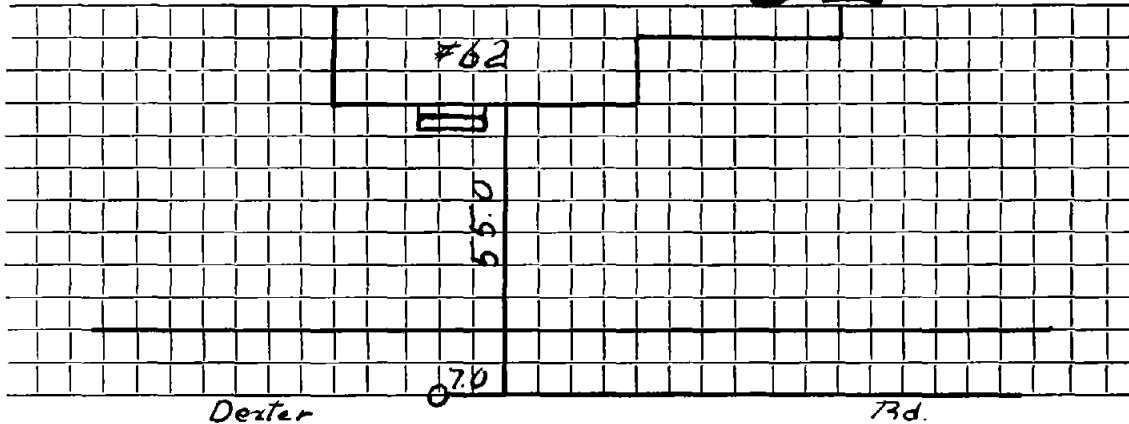

Connection made in Dexter Street.

Work completed 19..

Remarks: