

Name Joseph Coletta

Service No. 11

Address *86 Cedar St.

Location

Kind of Pipe

Size

Size of Main

~~Repair-Renewal~~ New Service

Location Comm 6-19-61

| Date | Material | Amount | Total | Date | | Amount |
|---------|---------------------------|--------|--------|---------|---------|--------|
| 3-27-61 | Labor | 87.59 | | 3-22-61 | Deposit | 266.00 |
| | 10% O.H. | 8.76 | 96.35 | 4-17-62 | Paid | 64.04 |
| | 86' 6" Transite pipe @.78 | | 67.08 | | | 364.04 |
| | 1 22 1/2° Transite Bend | | 6.21 | | | |
| | 1 90° Transite Elbow | | 5.40 | | | |
| | 26' 3 Patch | | 26.00 | | | |
| | 18' Driveway Patch | | 18.00 | | | |
| | 4 Hrs. Town Shovel @6.50 | | 26.00 | | | |
| | 4 Hrs. Trucking @3.00 | | 12.00 | | | |
| | 1 Hr. Loader @3.00 | | 3.00 | | | |
| | 1 Hr. Trailer @3.00 | | 3.00 | | | |
| | Material | | | | | |
| | 1 Hr. Pumping @1.00 | | 1.00 | | | |
| | | | 264.04 | | | |

TOWN OF LEXINGTON—DEPT. OF PUBLIC WORKS

SEWER DIVISION

DATE

NO.

The undersigned applies for the construction of a particular sewer connecting No.
Street and hereby agrees to comply with the Rules and Regulations governing the construction and use of Particular
Sewers, as now or at any future time established by the Board of Selectmen.

Am't of estimate \$.....

Am't Paid \$.....

..... Owner

Sketch of Service Here **86**

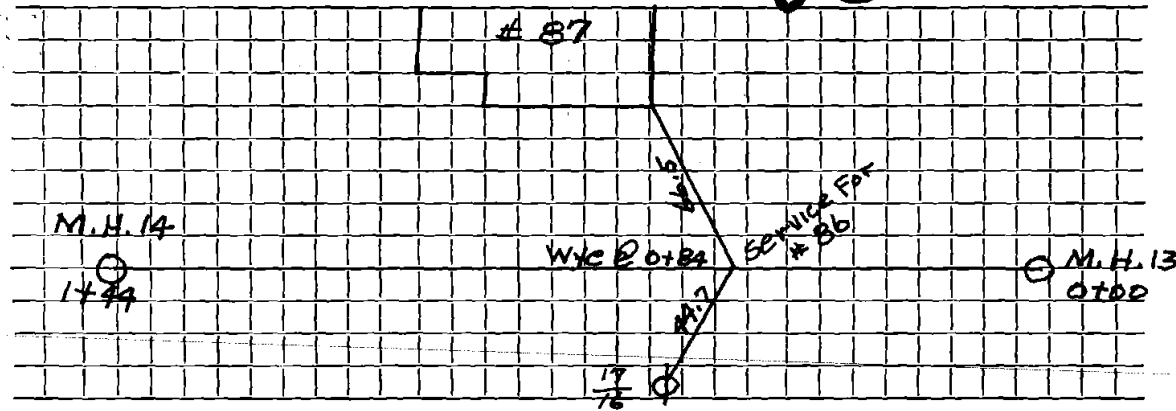

Connection made in Street.

Work completed 19..

Remarks: