



DATE 10-8-1999

TOWN OF LEXINGTON — BOARD OF PUBLIC WORKS

SEWER DIVISION

Sketch of Service Here

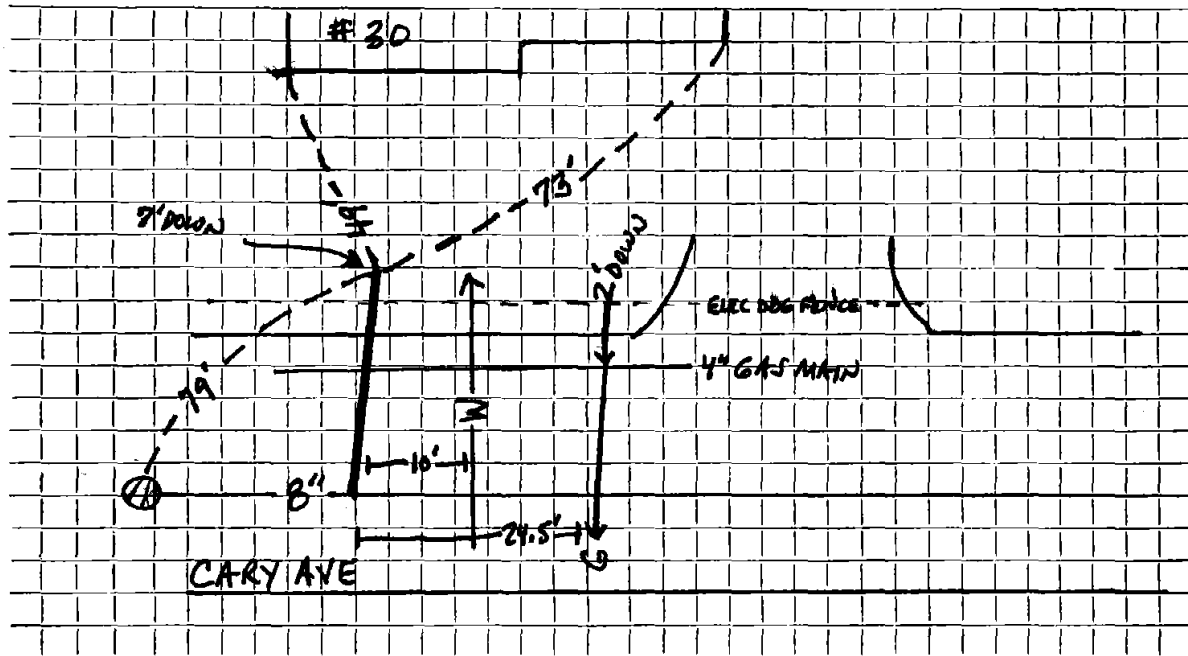

Connection made in ..... Street. Work completed .....

Remarks: 1" COPPER WATER SERVICE 10' FROM SEWER LAT / 4' DOWN

GAS SERVICE 24.5' FROM SEWER LAT / 1' DOWN

GAS MAIN 2' DOWN / ELECTRIC DOG (UNDERGROUND) FIBRE WIRE @ PROP LINE.

FIELD BOOK 99-12-1 PL 25  
D.F.