

Name

Service No.

Address 15 Carol Lane

Location #15 Carol Lane

Kind of Pipe

Size

Size of Main

Repair—Renewal—New Service DeFlice Bros

Location

Date

Material

Amount

Total

Date

Amount

9-12-68 35' 6" Transite pipe

10' 4" Cast Irone

DATE _____

TOWN OF LEXINGTON — BOARD OF PUBLIC WORKS
SEWER DIVISION

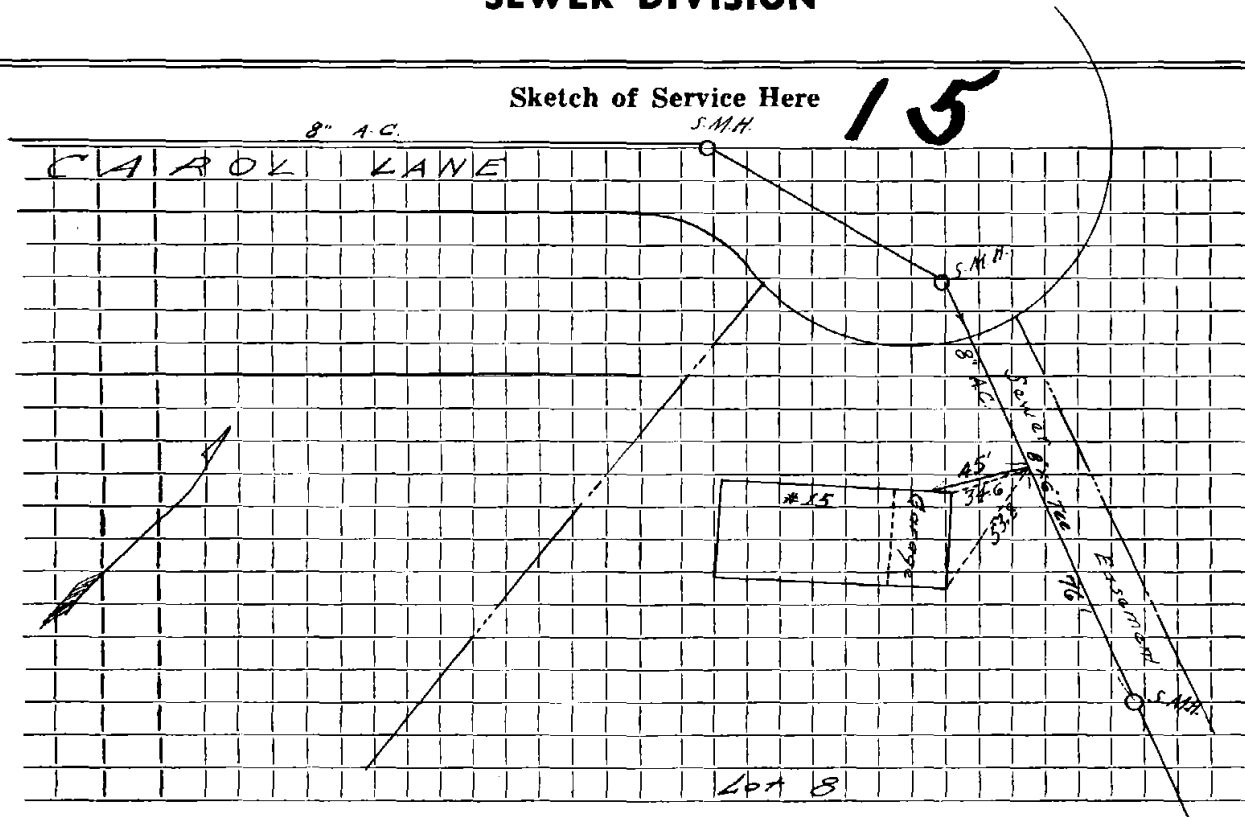

Connection made in Street. Work completed

Remarks:

.....

.....