

DATE 6/5/18

TOWN OF LEXINGTON — BOARD OF PUBLIC WORKS

SEWER DIVISION

Sketch of Service Here

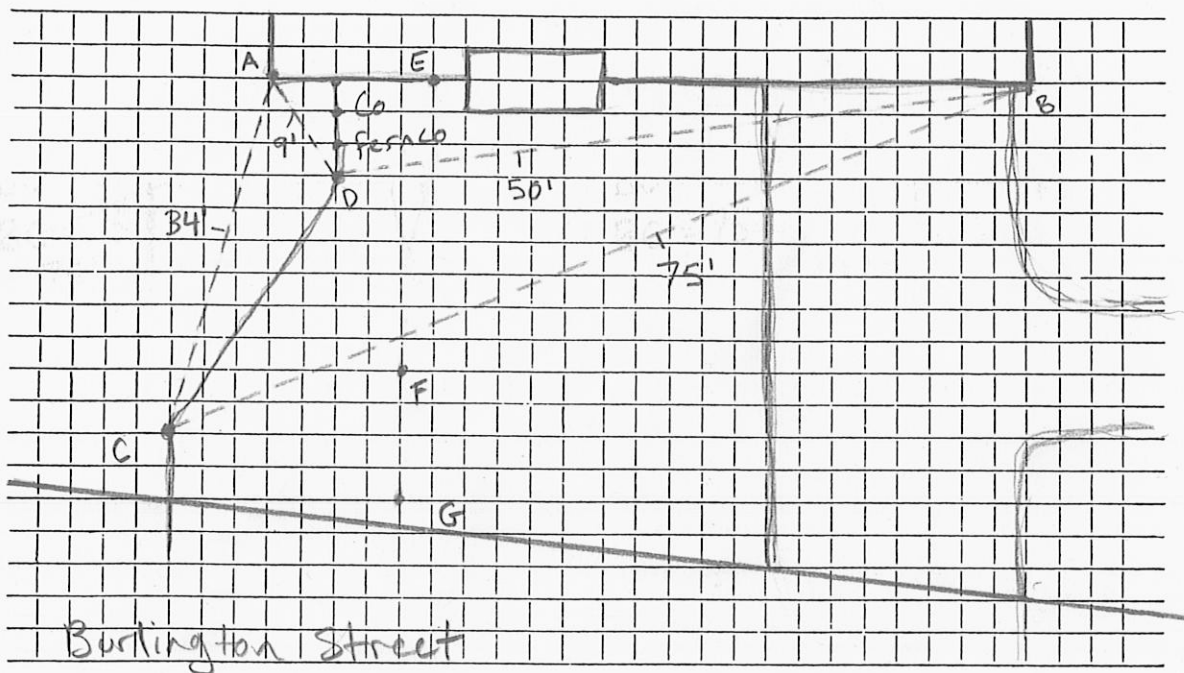

AD = 9'
AC = 34'
BD = 50'
BC = 75'

Connection made in ... Burlington ... Street. Work completed

Remarks: ... D + C are 22° Bends. ... 6" ferro