

Name Richard S. Batchelder

Service No. 98

Address 84 Bertwell Road

Location

Kind of Pipe

Size

Size of Main

~~Renewal~~ ~~Renewal~~ ~~New Service~~

Location DEC 28 1964

Date	Material	Amount	Total	Date	Amount
9-2-64	Labor	115 71		6-11-64	Deposit 125 00
	10% O.H.	11 57	127 28	3-11-64	Paid 5 10
	37' 6" Transite Pipe @.82		30 34		130 18
	1 11 1/4 Bend		4 09	11-17-88	15.7-6" PVC From
	2 11 1/2 Elbows @2.35		4 70		Property line to main
	3 Yds. Loam @3.00		9 00		2-8" cly PVC Furnced
	12 X 3 Patch		12 00		1-90° Elbow 1-6" Trans-PVC Furnc
	2 Hrs. Town Shovel @6.50		13 00		We will respond
	2 Hrs. Trucking @3.00		6 00		cost 45' out 9/27/88
	1 Hr. Loader @4.00		4 00		
			210 41	7-9-77	Roots
	PRO-RATED			11-24-84	Roots 12 @ 25
	210.41 X 15.5.16 = 130.10			11-1-67	Roots
				1-1-75	Roots
				3-31-77	Roots 12' 247
				8-17-85	Roots
				9-22-88	Roots

DATE \_\_\_\_\_

# TOWN OF LEXINGTON — BOARD OF PUBLIC WORKS

## SEWER DIVISION

Sketch of Service Here

**84**

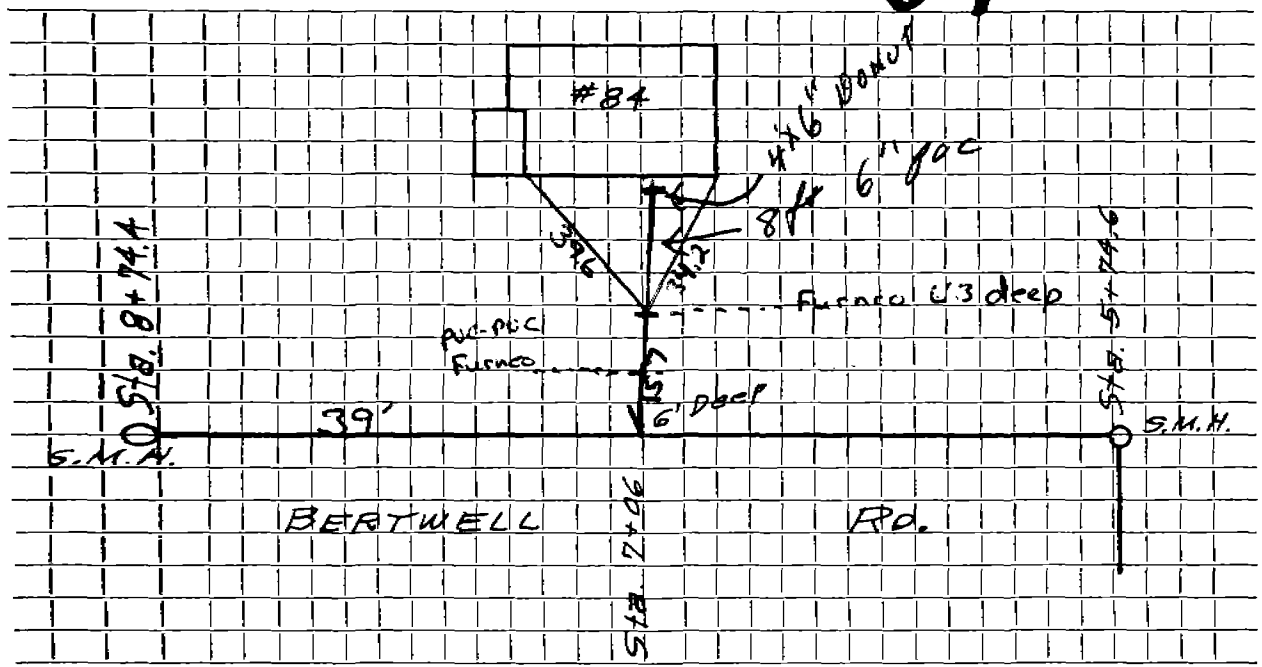

Connection made in ..... Street. Work completed .....

Remarks: .....  
.....  
.....