

DATE 6/8/2023

TOWN OF LEXINGTON — BOARD OF PUBLIC WORKS

SEWER DIVISION

Sketch of Service Here

distances by letter

A = 12'10"
B = 35'0"

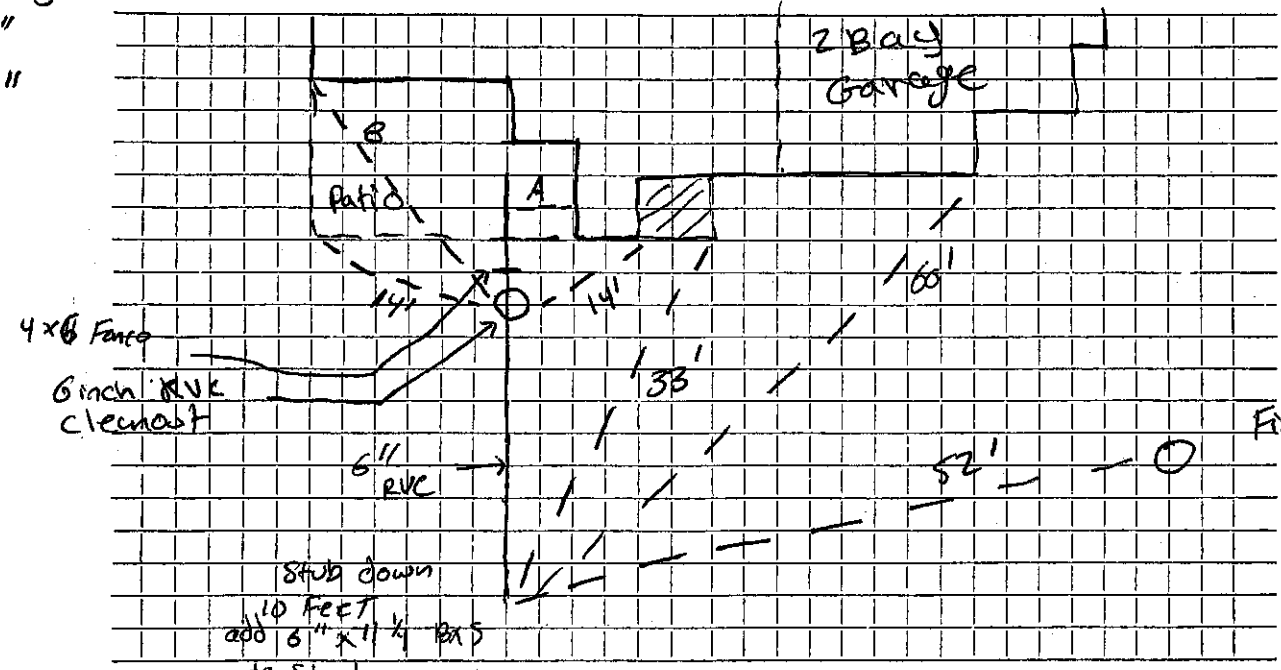

Foundation to 4x6 Fence = 5'
Foundation wall to 6" cleanout = 6'6"
Foundation wall to SW6 = 33'

Connection made in 6 Beech Tree Lane Street.

Work completed

Remarks: INSTALLED By McLAUGHLIN