

DATE _____

TOWN OF LEXINGTON — BOARD OF PUBLIC WORKS

SEWER DIVISION

Sketch of Service Here

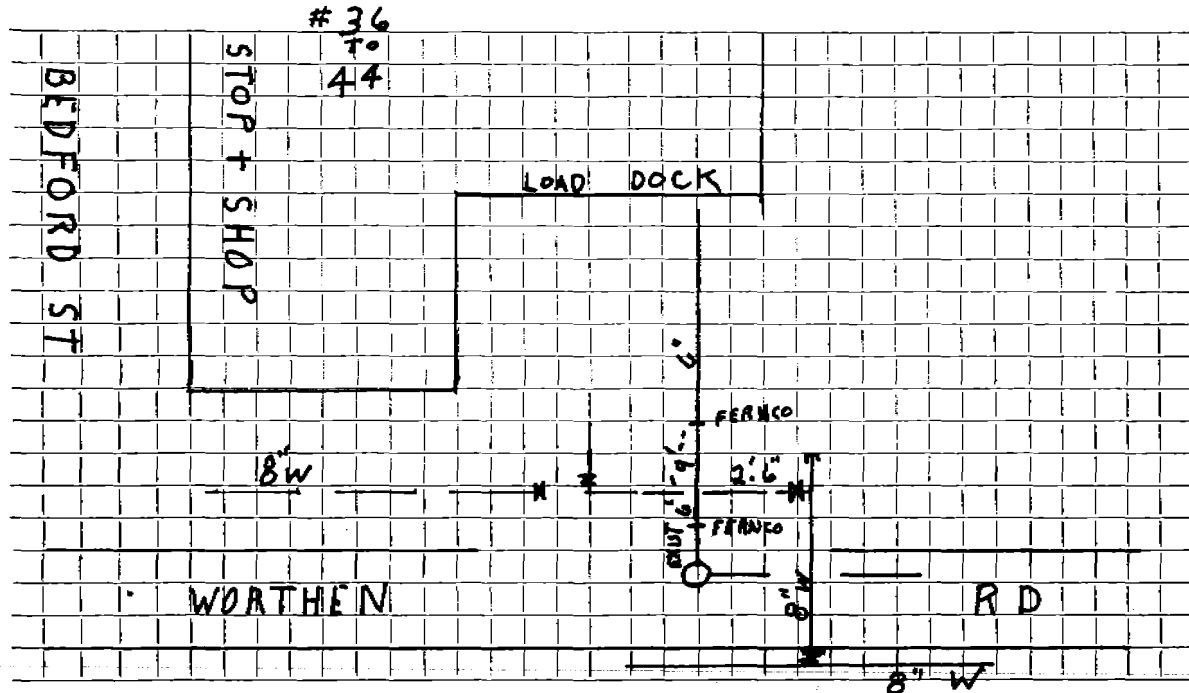

Connection made in WORTHEN RD. Street. Work completed 9/99.

Remarks: SEWER SERVICE GOES OVER WATER, ENCASED IN CONCRETE FOR 15' PVC
This 15' of PVC SEWER IS THE ONLY PART INSP. BY W/S DEPT.