

Name John Broderick

Service No. 282

Address 1 Barrymeade Drive

Location

Kind of Pipe

Size

Size of Main

~~Repair-Renewal~~ New Service

Location *Comm 3-6-61*

Date	Material	Amount	Total	Date	Amount
12-28-60	Labor	97.15		12-8-60	250.00
12-29-60	"	63.43	160.58	8-28-61	10.00
	10% O.H.	16.07	176.65	12-21-61	66.22
90'	6" Transite pipe @.78		70.20		NON CHARGE
2	6" 22 <sup>1</sup> / <sub>2</sub> Transite Bends @6.21		12.42	12-29-60	Labor
20	x 3 Patch		20.00		(Wait for Shovel - Broke down)
4	hrs. Town Shovel @6.50		26.00		
3	hrs. Trucking @3.00		9.00		
2	hrs. Compressor @3.00		6.00		
			<u>320.27</u>		

DATE \_\_\_\_\_

**TOWN OF LEXINGTON — BOARD OF PUBLIC WORKS**  
**SEWER DIVISION**

Sketch of Service Here

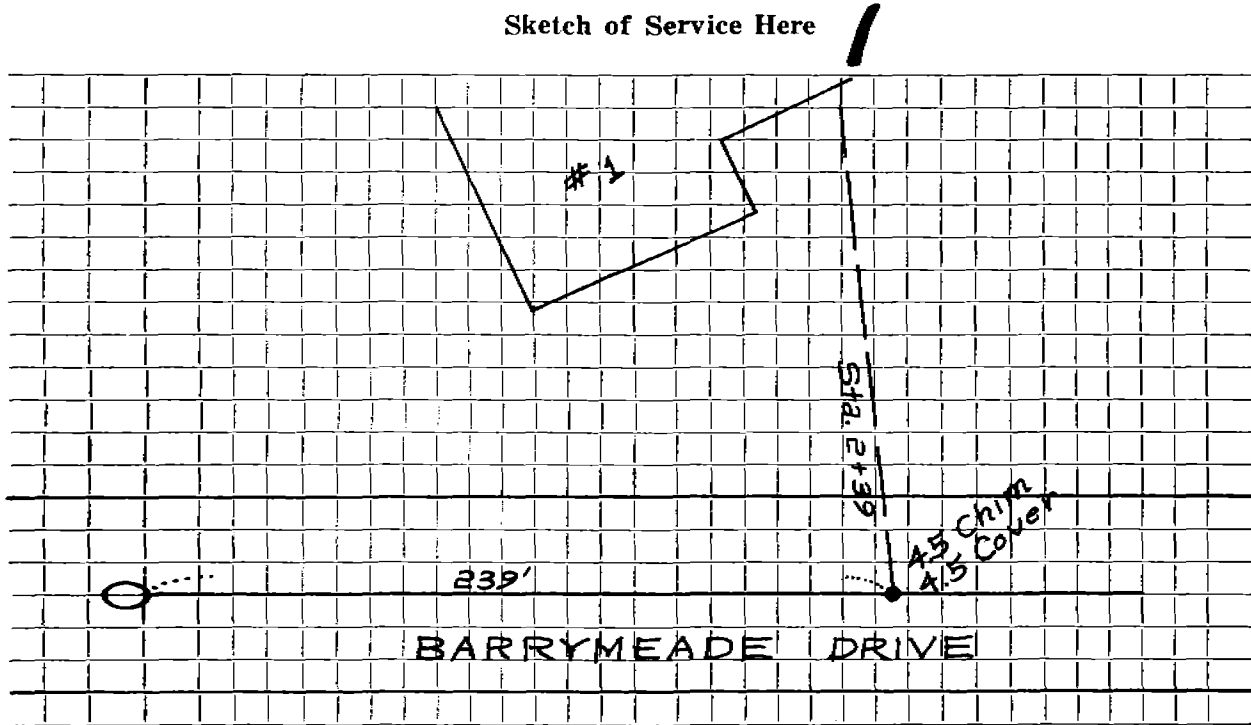

Connection made in ..... Street. Work completed .....

Remarks: .....  
.....  
.....