

Name Grace Heran

Service No. 111

Address # 25 ASBURY ST. (LOTS 458-463)

Location

Kind of Pipe

Size

Size of Main

~~Repair~~ ~~Repair~~ - New Service W O # 7487Location ~~Com~~ 10-29-62

Date	Material	Amount	Total	Date		Amount
8-11-61	Labor	46.32		7-24-62	Deposit	300.00
	10% O.H.	4.63	50.95	10-29-62	Refund	65.89
	30' 6" Transite pipe @.78		23.40			234.11
	1 6" Duplex Adapter		2.90			
	2 hrs. Town Shovel @6.50		13.00			
	1 hr. <del>TRUCKING</del> Trucking @3.00		3.00			
	1 hr. Loader @3.00		3.00			
	BILL WHEN CONNECTED		95.25			
8-21-62	Labor	52.14				
	10% O.H.	5.21	57.35			
	57' 6" Transite Pipe @82		46.74			
	2 11 1/2° Transite Bends @4.09		8.18			
	1 22 1/2° Transite Bend		4.09			
	3 Hrs. Town Shovel @5.50		16.50			
	2 Hrs. Trucking @3.00		6.00			
			234.11			

DATE \_\_\_\_\_

TOWN OF LEXINGTON — BOARD OF PUBLIC WORKS  
SEWER DIVISION

25

Sketch of Service Here

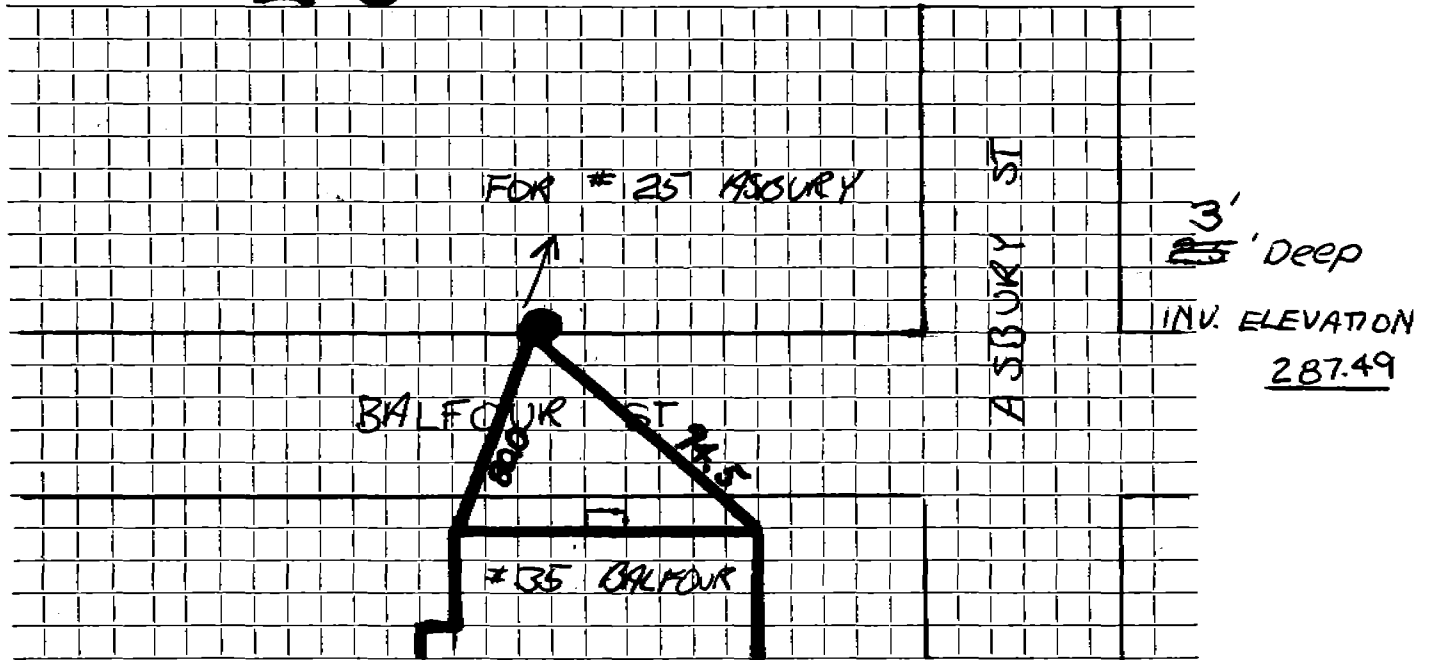

Connection made in ..... Street. Work completed .....

Remarks: .....

.....

.....