

Name Mr. Thomas Walsh

Service No. 16 13

Address 6 Ames Avenue

Lexington 73, Mass.

Location 6 Ames Avenue

Kind of Pipe

Size

Size of Main

Repair—Renewal—New Service

Location

Date	Material	Amount	Total	Date	Amount
Aug. 10 '44	Labor	11 20			90 00
11	"	8 60		Oct. 16 '44	41 77
16	"	8 60	28 40		48 23
	10% Overhead		2 84		
	58'-6" Sewer Pipe @ .22		12 76		
	Joint Comp.		3 48		
	1 hr. Trucking		75		
			48.23		
	Labor				

TOWN OF LEXINGTON—DEPT. OF PUBLIC WORKS

SEWER DIVISION

DATE

NO.

The undersigned applies for the construction of a particular sewer connecting No.
Street and hereby agrees to comply with the Rules and Regulations governing the construction and use of Particular
Sewers, as now or at any future time established by the Board of Selectmen.

Am't of estimate \$.....

Am't Paid \$.....

..... Owner

6 AMES

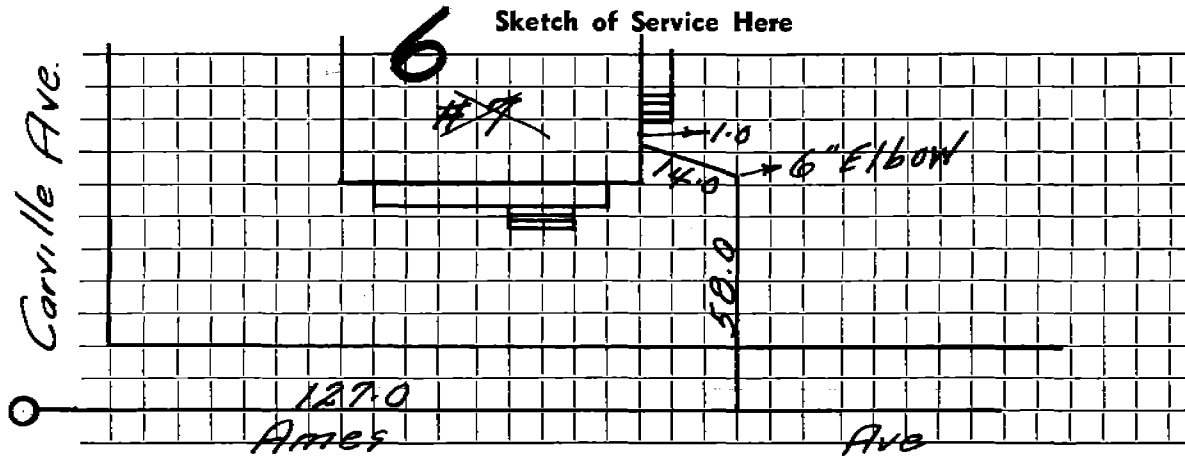

Connection made in Street.

Work completed 19..

Remarks: