

Name Moore Construction Co., Inc. of Woburn

Service No. 82

Address 94 Adams St.

Location

Kind of Pipe

Size

Size of Main

~~Repair~~ New Service Kirkland #2099 W O # 9799

Location DEC 18 1972

Date		Material	Amount	Total	Date	Amount
7/11/72	235'	6" Transite pipe			6-8-72	440 00
	10'	4" Cast Iron pipe			12-18-72	46 41
6/16/72		Labor	136 56			393 39
8/22/72		Police	61 27			
		O.H.	60 00			
	10%		25 78	283 61		
	20'	6" Transite pipe .90		18 00		<u>NO CHARGE</u>
	5'	6" Nipple .90		4 50	6/16/72	Labor 31 01
	1	coupling		1 78		
	1/2	Bag cement 1.98		50		
	1	Ton Cold patch		8 00		
	3	Ton Hot Top 8.00		24 00		
	7	Hrs. Trucking 3.00		21 00		
	2	Hrs. Shovel 6.50		13 00		
	3	Hrs. Compressor 5.00		15 00		
	1	Hr. Roller		2 00		
		Trailer		2 00		
				<u>393 39</u>		

DATE _____

TOWN OF LEXINGTON — BOARD OF PUBLIC WORKS

SEWER DIVISION

Sketch of Service Here

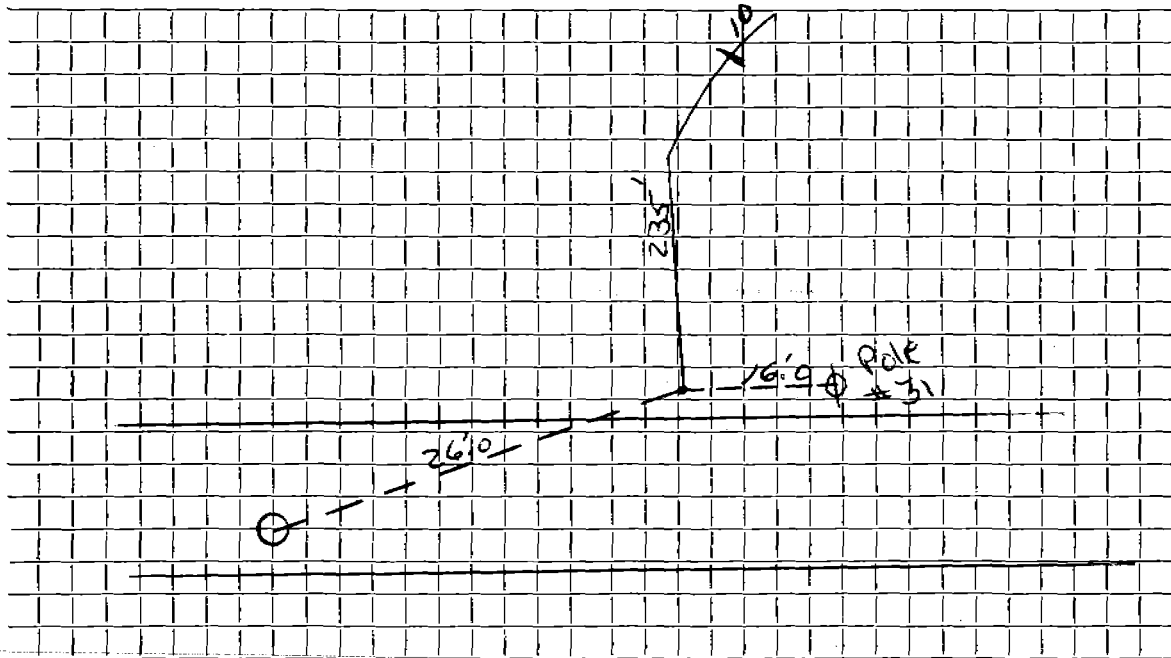

Connection made in Street. Work completed

Remarks:

.....

.....