

# Elevations Form

Address: \_\_\_\_\_

The following elevations are **required**, please fill out every line item.

1. Estimated Seasonal High Ground Water\* \_\_\_\_\_
2. Finished Basement Floor Elevation \_\_\_\_\_
3. Average Natural Grade \_\_\_\_\_
4. Finished First Floor Elevation\*\* \_\_\_\_\_
5. Top of Highest Ridge \_\_\_\_\_

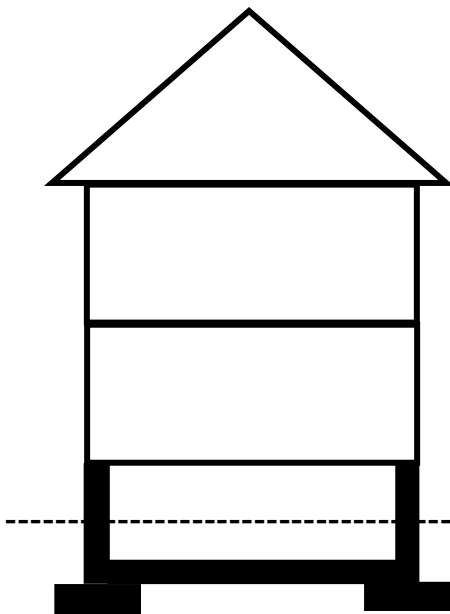

\*The vertical distance between the finished basement floor of any dwelling shall not be less than two (2) feet above the ESHGW, except that if all of the conditions are met as listed in Article 9 of the 2020 Special Town Meeting Warrant.

\*\*If the Finished First Floor elevation is more than six feet above the average natural grade, then the basement or crawl space is considered a story

----- # 3: Avg. Natural Grade \_\_\_\_\_

# 1: Estimated Seasonal High Ground Water \_\_\_\_\_

**Average Natural Grade** – The elevation of the natural grade prior to the disturbance for construction. In the case where the finished grade is lower than the natural grade, the finished grade shall be the lower elevation.

**Maximum Height of Dwellings** - 40 feet or 20 feet plus 4/3 times the shortest setback (measured from structure to property line), whichever is less. Please note that the height is measured to the top of the highest ridge on the structure.

\_\_\_\_\_  
Signature of Land Surveyor

\_\_\_\_\_  
License Number and Date