

# PROPOSED PARKING & ENTRANCE PLAN

## Characteristics

- Trail accessible from Revere St
- Emergency vehicle access directly from Revere Street
- Smaller gate restricts vehicles, but is more pedestrian-friendly
- Footpath provides additional point of access onto the trail
- Maximizes pervious surfaces
- Balances vegetation removal with safe and efficient parking layout

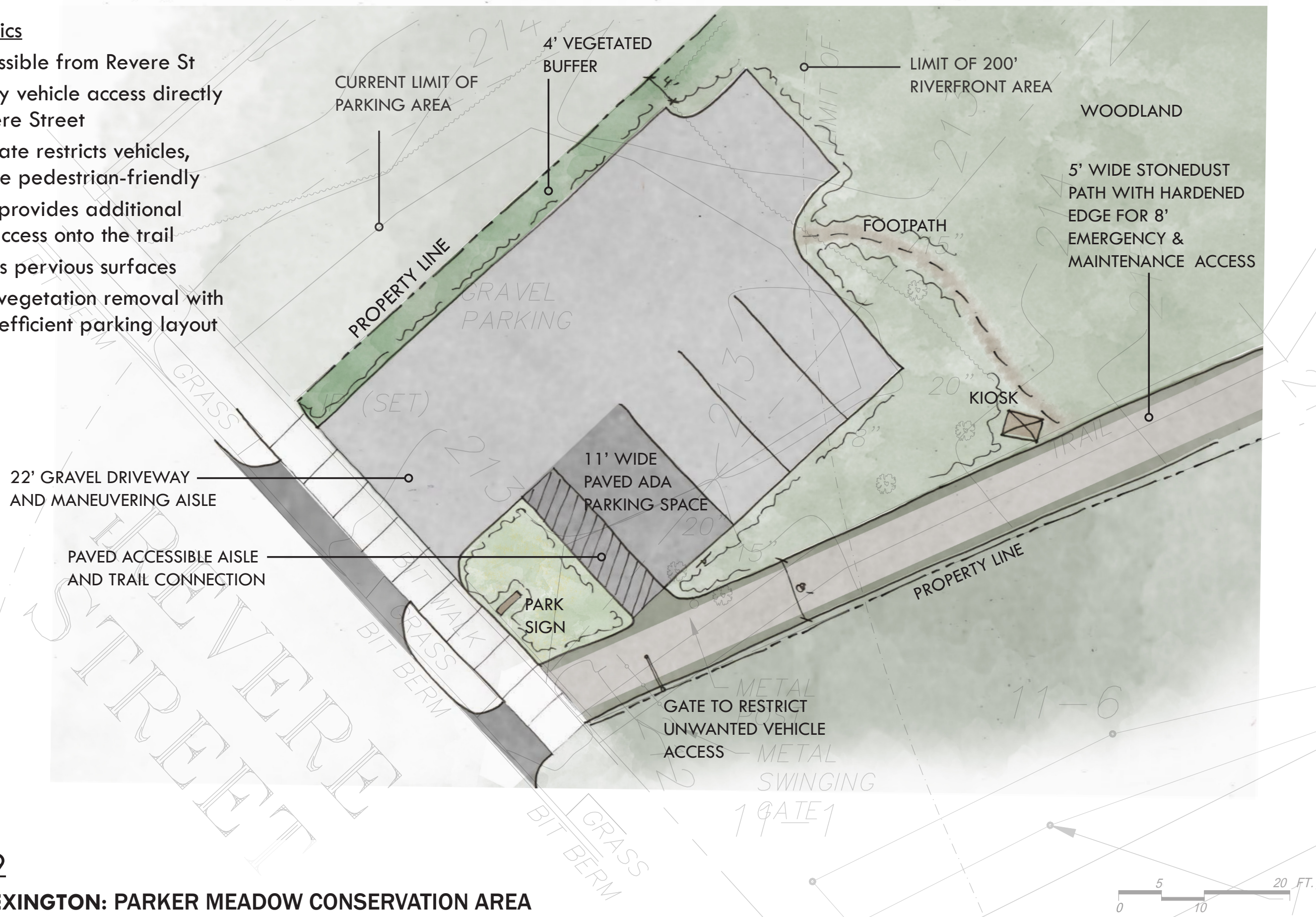

12-31-19

TOWN OF LEXINGTON: PARKER MEADOW CONSERVATION AREA

# PROPOSED TRAIL PLAN A

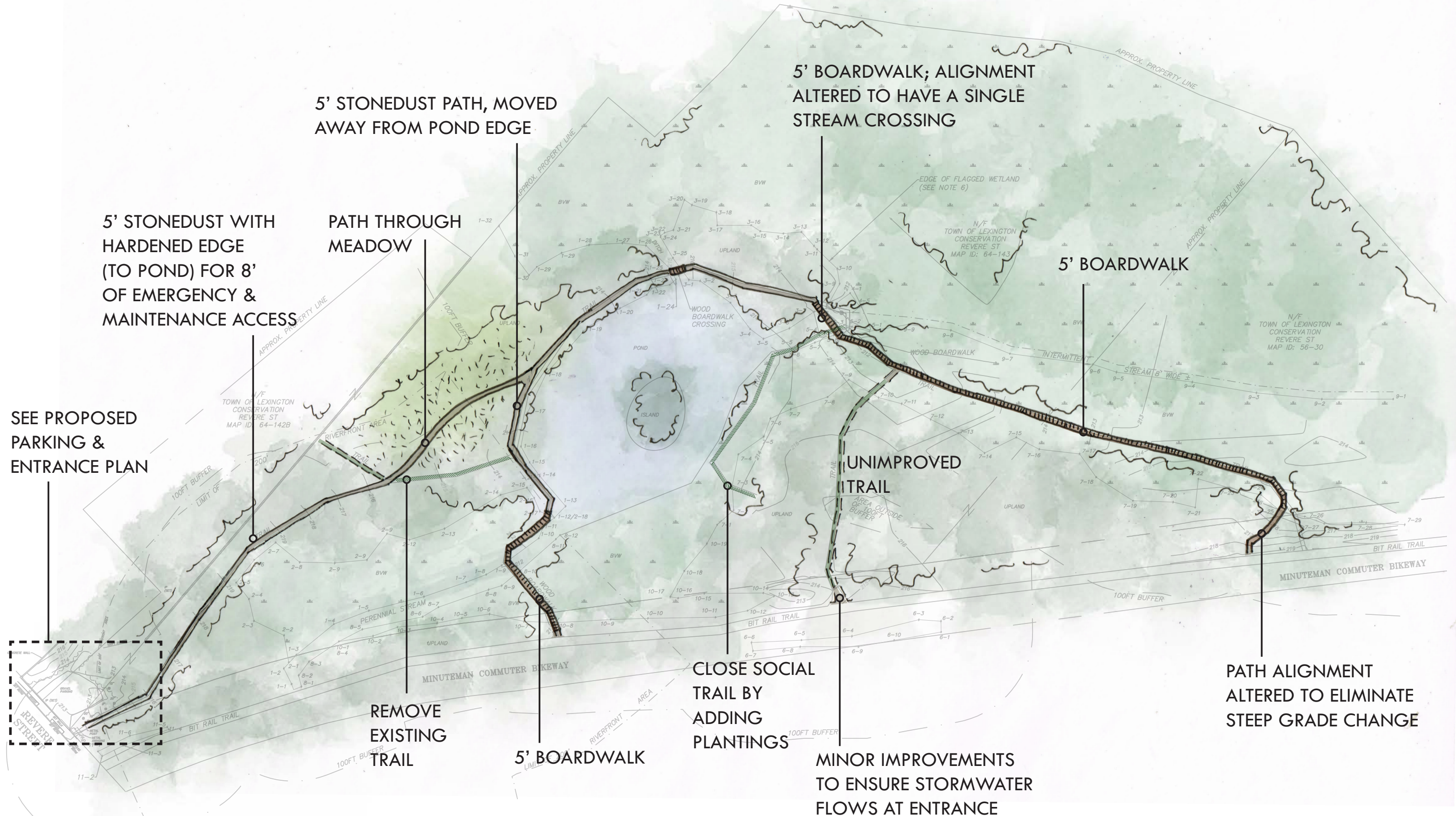

5' STONEDUST PATH, MOVED AWAY FROM POND EDGE

5' BOARDWALK; ALIGNMENT ALTERED TO HAVE A SINGLE STREAM CROSSING

5' STONEDUST WITH HARDENED EDGE (TO POND) FOR 8' OF EMERGENCY & MAINTENANCE ACCESS

PATH THROUGH MEADOW

5' BOARDWALK

SEE PROPOSED PARKING & ENTRANCE PLAN

UNIMPROVED TRAIL

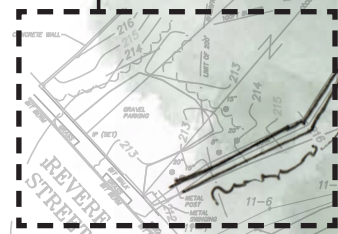

REMOVE EXISTING TRAIL

5' BOARDWALK

CLOSE SOCIAL TRAIL BY ADDING PLANTINGS

MINOR IMPROVEMENTS TO ENSURE STORMWATER FLOWS AT ENTRANCE

PATH ALIGNMENT ALTERED TO ELIMINATE STEEP GRADE CHANGE

12-31-19

TOWN OF LEXINGTON: PARKER MEADOW CONSERVATION AREA



